

1940Z MINI IP

19*40W IP65 19x40W MINI Wash Zoom

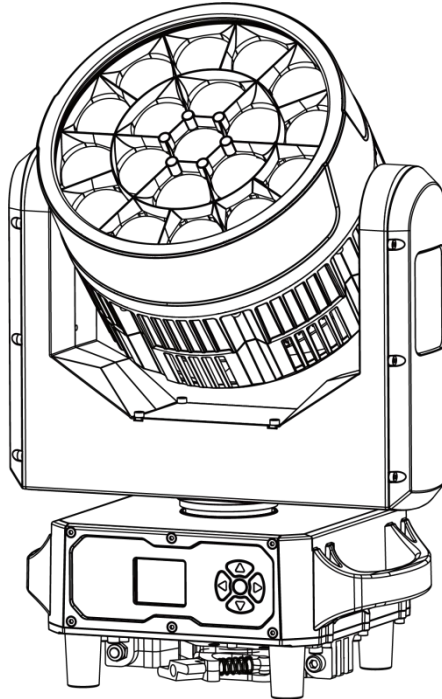

User Manual
Please read manual carefully before use

CONTENTS

1. Safety Instructions	2
2. Technical Specification	5
3. DMX Set Up	6
4. Display	7
5. Menu	8
6. LUX Data	10
7. DMX Channel List	11
8. Mounting	24
9. Product Size	25
10. Attention	26
11. Trouble Shooting	26
A. The unit does not work, no light and the fan does not work	26
B. No response to DMX controller	26
C. One of the channels is not working well	27
12. Fixture Cleaning	27

Thank you for choosing our LED lights. Each facility has been rigorously tested. Please check whether the facility has been damaged during transportation. If you find any parts are missing or broken, please contact the manufacturer immediately. Please do not return the product without any notice!

1.Safety Instructions



Please read this manual carefully, which includes important information on installation, use and maintenance.

Attention

- Please keep this USER MANUAL for future consultation. If you sell the facility to another user, be sure that they also receive this USER MANUAL.
- Please open and check in details and make sure there is no transportation damage.
- Before operating, ensure that the voltage and frequency of power supply match the power requirements of the facility.
- It's important to ground the yellow/green conductor to earth in order to avoid electric shock.
- The facility must be installed in a location with adequate ventilation, at least 50 cm from adjacent surfaces. Be sure that no ventilation slots are blocked.
- Make sure the power is disconnected before removing the facility.
- Make sure there are no flammable materials close to the unit while operating as it is fire hazard.
- Use safety cable when fixes this facility. Do not handle the facility by taking its head only, but always by taking its base.
- Maximum ambient temperature is 40 °C . Do not operate it where the temperature is higher than this.
- Please stop using the facility for serious operating problems. Stop using the facility immediately. Never try to repair the facility by yourself, but be a professional technician. Please contact the supplier's service department

for technical support.

- Do not touch any wire during operation as high voltage might be causing electric shock.
- When the housing or lens is damaged, it must be replaced.
- Direct sunlight or any other strong light source penetrating the lens of the light will cause serious internal damage to the facility. During unpacking, installation, use and long-term outdoor idleness, it is forbidden to expose the lens of the facility to direct sunlight or any other strong light source at any angle. It is forbidden to aim the beam of one light directly at another light.

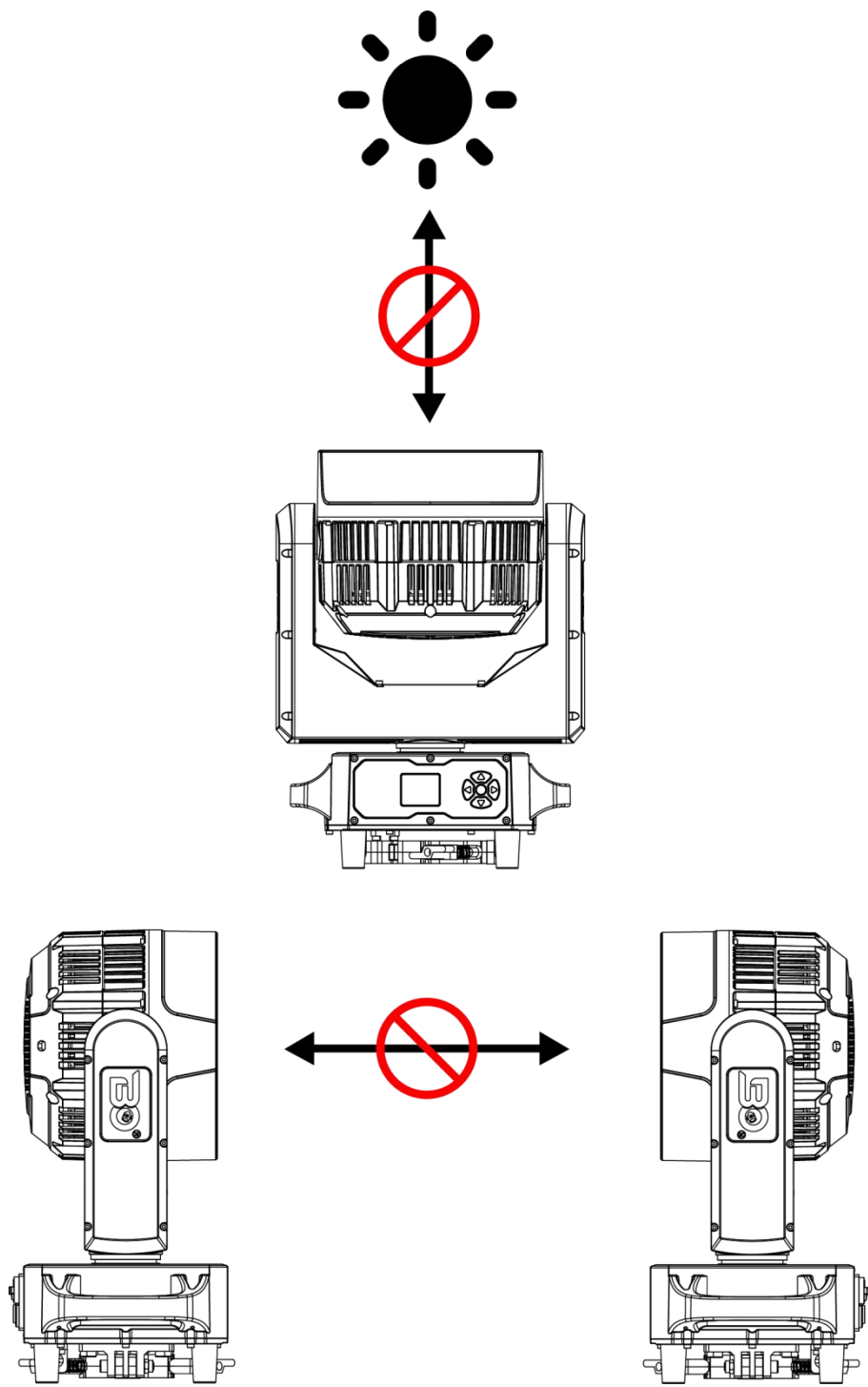

Caution

There are no accessories available, do not open the housing and try to repair the facilities yourself. Please contact our company for after service.

Installation

The unit should be mounted via its screw holes on the bracket. Always ensure that the unit is firmly fixed to avoid vibration and slipping while operating. And make sure that the structure to which you are attaching the unit is secure and is able to support a weight of 10 times of the unit's weight. Also always use a safety cable that can hold 12 times of the weight of the unit when installing the fixture.

The facility must be installed by professionals, and keep it far away from fire, walking road, and easy touched place.

2. Technical Specification

Light Source	19 x 40W 4in1 RGBW LED
LED Lifetime	≥ 50000H
Power Voltage	AC100-240V , 50-60Hz
Power Consumption	650W±5 W
Beam Angle	3.5°~48°
Control Modes	DMX512/ Auto/ Sound/ Master/ Manual/ RDM/ArtNet
DMX Channel	17/21/22/27/30/12 (DMX+ArtNet) Channel
Protection Rating	IP65
Display	1.8°TFT Color Display,Can be rotated 180°,Chinese and English can be switched
Data In/Out Socket	IP65 3-pin & 5-pin XLR sockets
Power Socket	IP65 Power-Con in/ out
Housing Material	Die casting + flame retardant black carbon fiber

Work temperature	-10℃～45℃		
Pan	540°accuracy 2.11°/step, fine-tuning accuracy: 0.008°		
Tilt	270°accuracy 0.86°/step, fine-tuning accuracy: 0.0034°		
Pan/Tilt Resolution	Automatically correct pan/tilt position		
MAX. Connection	7 units (240V, 50Hz)	1.5mm ²	power cable
	3 units (100V, 60Hz)	1.5mm ²	power cable
Dimension	341*250*463mm		
Net Weight	13.5kg		
Carton Package	580mm*370mm*450mm	1in1	GW: 16.5 kg
Flight Case	830mm*740mm*670mm	4in1	GW: 94 kg
Features	Circle control effect, large zoom range, wide wash area, RGBW color mixing system, full light range dimming; smooth and uniform, low noise and high efficiency fan cooling system; fast strobe 1~25Hz; preset multiple color macro functions; preset multiple effect macro functions		
Configuration	Signal cable	1pc	
	Power cable	1pc	
	Manual	1pc	

3. DMX Set Up

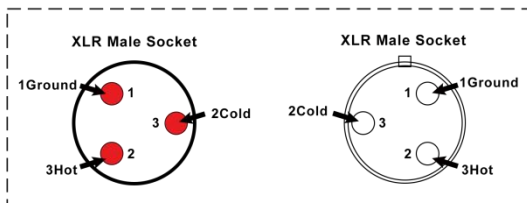
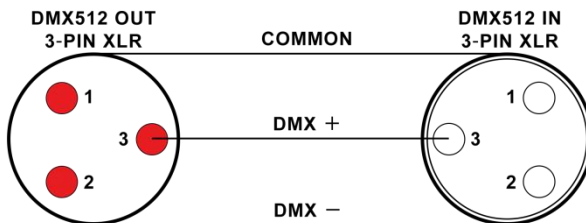

XLR Pin Configuration
pin 1=Ground
pin 2=Data Compliment (negative)
pin 3=Data true (positive)

Pin1: Ground

pin2: Negative

pin3: Positive

DMX Connection

To ensure optimal transmission of DMX data, please connect facilities in the shortest way. The connection order won't affect the DMX address code. For example, if the address code is set to 1, no matter where the facility is connected, its address code will not change. This is determined by the principle of the DMX controller.

Operation method

You can operate in the following three modes:

- Auto mode - the light can automatically complete all color changes
- DMX control mode - each light can be individually controlled by a standard DMX512 console
- Master mode - any light can work as a host in any of the above modes, and the other lights will work synchronously as slaves

4. Display

There are four buttons on the LED panel: MENU, UP, DOWN, and ENTER.



MENU



UP



DOWN



ENTER

Please press the "MENU" to exit or return to the previous menu, press "UP" or "DOWN" to select the upper and lower menus or adjust the values, and press "ENTER" to confirm.

FRONT VIEW

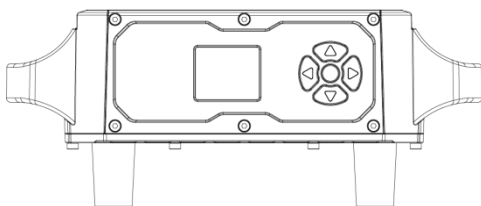

REAR VIEW

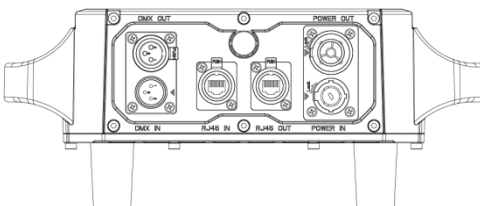

After powering on, the facility will automatically return to the last operation when it was powered off, then get into standby status. For more details, please refer to the information below↓

5. Menu

1-MENU 2-UP 3-DOWN 4-ENTER			
Menu	1.Pan Degree	1.540 2.360	Pan running angle selection
	2.Mic Sense	001-100	Sound sensitivity
	3.Language	1.English	Select Display Language
		2.Chinese	
	4.No Signal	1.Blackout 2.Hold	
	5.Fan Set	1.Auto 2.Low 3.High	Setting fan speed
	6.Reset	1.Yes	Reset
		2.No	
	7.Default	1.Yes	Factory setting
		2.No	
	8.Adjust	Pass Word: ****	Change the value of Pan/Tilt/Focus/Rota to correct the angle; change the value of R/G/B/W to adjust the white balance.
		1.Pan: 0-255	
		2.Tilt: 0-255	
		3.Focus: 0-255	
		4.Rota: 0-255	

			4.Red: 0-255	
			5.Greed: 0-255	
			6.Blue: 0-255	
			7.White: 0-255	
Address			001-512	Setting the address from 001-512
Reverse	1.Pan		1.YES 2.NO	Pan/Tilt/Display
	2.Tilt		1.YES 2.NO	Font Forward and Reverse Switching
	3.Display		1.YES 2.NO	
Informati on			1.CH Value	Show all channel information
			2.Tem**℃	Show the temperature of LED board
			3.Soft V1.0	Program version number
Mode	1.DMX512			Setting control mode
	2.Auto		1.Master	
			2.Alone	
	3.Sound		1.Master	
			2.Alone	
	4.Manu al	1.Mast er	1.Pan:0-255	Manual control
			2.Tilt:0-255	
			3.Focus:0-255	
			4.Red:0-255	
		2.Alone	5.Green: 0-255	
			6.Blue: 0-255	
			7.White: 0-255	
			8.Strobe: 0-255	
	5.ArtNe t(Option al)			

Channel	1.17 CH	1.17Channels	Select channel mode
	2.21 CH	2.21Channels	
	3.22 CH	3.22Channels	
	4.27 CH	4.27Channels	
	5.30 CH	5.30Channels	
	6.12 CH (Artnet)	6.12Channels	

6. LUX Data

Beam Angle = 3.5°

R lux	81000	9000	3240	1653	810
G lux	170750	18972	6830	3485	1708
B lux	29750	3306	1190	607	298
W lux	216250	24028	8650	4413	2163
4in1 lux	452500	50278	18100	9235	4525

Beam Angle = 48°

R lux	3425	381	137	69.9	34.3
G lux	6925	769	277	141	69.3
B lux	1308	145	52.3	26.7	13.1
W lux	8475	942	339	173	84.8
4in1 lux	18100	2011	724	369	181

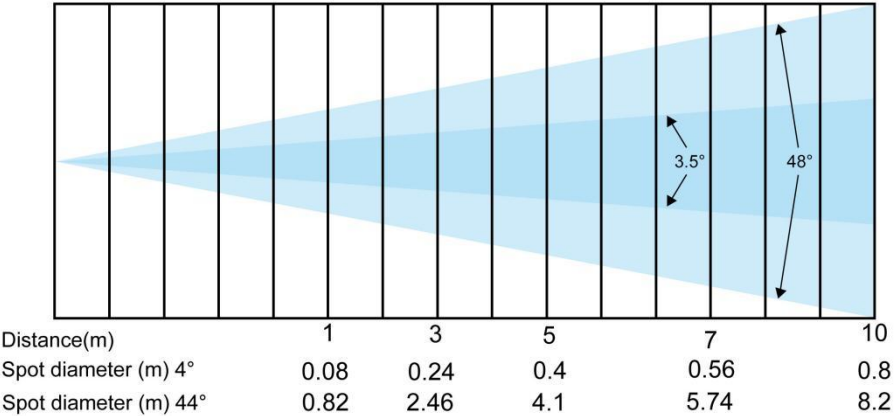

7. DMX Channel List

► 17CH Mode

CH	Function	DMX Value	Description
1	Pan	0-255	Pan adjustment
2	Pan adjustment	0-255	Pan fine adjustment
3	Tilt	0-255	Tilt adjustment
4	Tilt adjustment	0-255	Tilt fine adjustment
5	Pan/Tilt speed	0-255	from fast to slow
6	Zoom	0-255	From narrow to wide
7	Dimmer	0-255	From dark to bright
8	Dimmer adjustment	0-255	From dark to bright
9	Strobe	0-3	Strobe dimming
		4-203	Synchronous strobe speed from slow to fast (1Hz-25Hz)
		204-255	Random Strobe
10	R dimming	0-255	From dark to bright
11	G dimming	0-255	From dark to bright
12	B dimming	0-255	From dark to bright
13	W dimming	0-255	From dark to bright
14	Color temperature	0-15	No function
		16-35	R 100%,G UP,B 0%
		36-55	R DOWN,G 100%,B 0%
		56-75	R 0%,G 100%,B UP

CH	Function	DMX Value	Description
		76-95	R 0%,G DOWN,B 100%
		96-115	R UP,G 0%,B 100%
		116-135	R 00%,G 0%,B DOWN
		136-155	R 100%,G UP,B UP
		156-175	R DOWN,G DOWN,B 100%
		176-195	R 100%,G 100%,B 100%,W 100%
		196-200	2800 K
		201-205	3200 K
		206-210	3700 K
		211-215	4000 K
		216-220	4500 K
		221-225	5000 K
		226-230	5600 K
		231-235	6000 K
		236-240	6500 K
		241-245	7000 K
		246-250	7500 K
		251-255	8000 K
15	Pattern	0-9	No function
		10-19	Static pattern 1
		20-29	Static pattern 2
	(10in 1)

CH	Function	DMX Value	Description
		60-69	Static pattern 6
		70-79	Dynamic pattern 1
		80-89	Dynamic pattern 2
	(10in 1)
		170-179	Dynamic pattern 11
		180-255	Dynamic pattern 12
16	Dynamic pattern Speed (with 15 channel)	0--9	No function
		10--132	Forward, from fast to slow
		133--255	Reverse direction, from slow to fast
17	Function	0-137	No Function
		138-149	PWM output frequency 1K-64K (stay for 3 seconds) 1K, 2K, 4K, 6K, 8K, 10K, 16K, 20K, 24K, 32K, 48K, 64K
		150-159	Fast dimming
		160-169	Slow dimming (From fast to slow)
		170-250	No Function
		251-255	Reset (stay for 3 seconds)

► 21CH Mode

CH	Function	DMX Value	Description
1	Pan	0-255	Pan adjustment
2	Pan adjustment	0-255	Pan fine adjustment

CH	Function	DMX Value	Description
3	Tilt	0-255	Tilt adjustment
4	Tilt adjustment	0-255	Tilt fine adjustment
5	Pan/Tilt speed	0-255	from fast to slow
6	Zoom	0-255	From narrow to wide
7	Function	0-137	No Function
		138-149	PWM output frequency 1 K-64 K (stay for 3 seconds) 1 K, 2 K, 4 K, 6K, 8K, 10K, 16K, 20K, 24K, 32K, 48K, 64K
		150-159	Fast dimming
		160-169	Slow dimming (From fast to slow)
		170-250	No Function
		251-255	Reset (stay for 3 seconds)
8	Dimmer	0-255	From dark to bright
9	Strobe	0-3	Strobe dimming
		4-203	Synchronous strobe speed from slow to fast (1Hz-25Hz)
		204-255	Random Strobe
10	R1 LED dimming	0-255	R 1 LED dimming
11	G1 LED dimming	0-255	G 1 LED dimming
12	B1 LED dimming	0-255	B 1 LED dimming
13	W1 LED dimming	0-255	W 1 LED dimming
14	R2 LED dimming	0-255	R 2 LED dimming
15	G2 LED dimming	0-255	G 2 LED dimming
16	B2 LED dimming	0-255	B 2 LED dimming
17	W2 LED dimming	0-255	W 2 LED dimming
18	R3 LED dimming	0-255	R 3 LED dimming
19	G3 LED dimming	0-255	G 3 LED dimming
20	B3 LED dimming	0-255	B 3 LED dimming

CH	Function	DMX Value	Description
21	W3 LED dimming	0-255	W 3 LED dimming

► 22CH Mode

CH	Function	DMX Value	Description
1	Pan	0-255	Pan adjustment
2	Pan adjustment	0-255	Pan fine adjustment
3	Tilt	0-255	Tilt adjustment
4	Tilt adjustment	0-255	Tilt fine adjustment
5	Pan/Tilt speed	0-255	from fast to slow
6	Zoom	0-255	From narrow to wide
7	Dimmer	0-255	From dark to bright
8	Dimmer adjustment	0-255	From dark to bright
9	Strobe	0-3	Strobe dimming
		4-203	Synchronous strobe speed from slow to fast (1Hz-25Hz)
		204-255	Random Strobe
10	R dimming	0-255	From dark to bright
11	G dimming	0-255	From dark to bright
12	B dimming	0-255	From dark to bright
13	W dimming	0-255	From dark to bright
14	Color temperature	0-15	No function
		16-35	R 100%,G UP,B 0%
		36-55	R DOWN,G 100%,B 0%
		56-75	R 0%,G 100%,B UP
		76-95	R 0%,G DOWN,B 100%
		96-115	R UP,G 0%,B 100%
		116-135	R 100%,G 0%,B DOWN
		136-155	R 100%,G UP,B UP
		156-175	R DOWN,G DOWN,B 100%

CH	Function	DMX Value	Description
		176-195	R 100%,G 100%,B 100%,W 100%
		196-200	2800 K
		201-205	3200 K
		206-210	3700 K
		211-215	4000 K
		216-220	4500 K
		221-225	5000 K
		226-230	5600 K
		231-235	6000 K
		236-240	6500 K
		241-245	7000 K
		246-250	7500 K
		251-255	8000 K
15	Macro color	0-9	No function
		10-19	Macro color 1
		20-29	Macro color 2
	(10 in 1)
		190-199	Macro color 19
		200-255	Macro color 20
16	Pattern	0-9	No function
		10-19	Static pattern 1
		20-29	Static pattern 2
	(10 in 1)
		60-69	Static pattern 6
		70-79	Dynamic pattern 1
		80-89	Dynamic pattern 2
	(10 in 1)
		170-179	Dynamic pattern 11
		180-255	Dynamic pattern 12

CH	Function	DMX Value	Description
17	Dynamic pattern Speed (with 16 channel)	0--9	No function
		10--132	Forward, from fast to slow
		133--255	Reverse direction, from slow to fast
18	Background color R	0-255	From dark to bright dimming
19	Background color G	0-255	From dark to bright dimming
20	Background color B	0-255	From dark to bright dimming
21	Background color W	0-255	From dark to bright dimming
22	Function	0-137	No Function
		138-149	PWM output frequency 1K-64K (stay for 3 seconds) 1K, 2K, 4K, 6K, 8K, 10K, 16K, 20K, 24K, 32K, 48K, 64K
		150-159	Fast dimming
		160-169	Slow dimming (From fast to slow)
		170-250	No Function
		251-255	Reset (stay for 3 seconds)

► 27CH Mode

CH	Function	DMX Value	Description
1	Pan	0-255	Pan adjustment
2	Pan adjustment	0-255	Pan fine adjustment
3	Tilt	0-255	Tilt adjustment
4	Tilt adjustment	0-255	Tilt fine adjustment
5	Pan/Tilt speed	0-255	from fast to slow
6	Zoom	0-255	From narrow to wide
7	Dimming	0-49	Linear dimming

CH	Function	DMX Value	Description
	curve	50-99	Square rate dimming
		100-149	Inverse square rate dimming
		150-255	S curve dimming
8	Function	0-137	No Function
		138-149	PWM output frequency 1K-64K (stay for 3 seconds) 1K, 2K, 4K, 6K, 8K, 10K, 16K, 20K, 24K, 32K, 48K, 64K
		150-159	Fast dimming
		160-169	Slow dimming (From fast to slow)
		170-250	No Function
		251-255	Reset (stay for 3 seconds)
9	Dimmer	0-255	From dark to bright
10	Dimmer adjustment	0-255	Dimmer adjustment
11	Strobe	0-3	Strobe dimming
		4-203	Synchronous strobe speed from slow to fast (1Hz-25Hz)
		204-255	Random Strobe
12	Red	0-255	Red dimming
13	Green	0-255	Green dimming
14	Blue	0-255	Blue dimming
15	White	0-255	White dimming
16	R 1 LED dimming	0-255	R 1 LED dimming
17	G 1 LED dimming	0-255	G 1 LED dimming
18	B 1 LED dimming	0-255	B 1 LED dimming
19	W 1 LED dimming	0-255	W 1 LED dimming
20	R 2 LED dimming	0-255	R 2 LED dimming

CH	Function	DMX Value	Description
21	G 2 LED dimming	0-255	G 2 LED dimming
22	B 2 LED dimming	0-255	B 2 LED dimming
23	W 2 LED dimming	0-255	W 2 LED dimming
24	R 3 LED dimming	0-255	R 3 LED dimming
25	G 3 LED dimming	0-255	G 3 LED dimming
26	B 3 LED dimming	0-255	B 3 LED dimming
27	W 3 LED dimming	0-255	W 3 LED dimming

► 30CH Mode

CH	Function	DMX Value	Description
1	Pan	0-255	Pan adjustment
2	Pan adjustment	0-255	Pan fine adjustment
3	Tilt	0-255	Tilt adjustment
4	Tilt adjustment	0-255	Tilt fine adjustment
5	Pan/Tilt Speed	0-255	from fast to slow
6	Zoom	0-255	Zoom
7	dimming curve	0-49	Linear dimming
		50-99	Square rate dimming
		100-149	Inverse square rate dimming
		150-255	S curve dimming
8	Dimmer	0-255	From dark to bright
9	Dimmer adjustment	0-255	dimming adjustment
10	Strobe	0-3	Strobe dimming
		4-203	Synchronous strobe speed

CH	Function	DMX Value	Description
			from slow to fast (1Hz-25Hz)
		204-255	Random Strobe
11	Red	0-255	Red dimming
12	Red adjustment	0-255	Red adjustment
13	Green	0-255	Green dimming
14	Green adjustment	0-255	Green adjustment
15	Blue	0-255	Blue dimming
16	Blue adjustment	0-255	Blue adjustment
17	White	0-255	White dimming
18	White adjustment	0-255	White adjustment
19	Color temperature	0-15	No function
		16-35	R 100%,G UP,B 0%
		36-55	R DOWN,G 100%,B 0%
		56-75	R 0%,G 100%,B UP
		76-95	R 0%,G DOWN,B 100%
		96-115	R UP,G 0%,B 100%
		116-135	R 100%,G 0%,B DOWN
		136-155	R 100%,G UP,B UP
		156-175	R DOWN,G DOWN,B 100%
		176-195	R 100%,G 100%,B 100%,W 100%
		196-200	2800 K
		201-205	3200 K
		206-210	3700 K
		211-215	4000 K
		216-220	4500 K
		221-225	5000 K

CH	Function	DMX Value	Description
		226-230	5600 K
		231-235	6000 K
		236-240	6500 K
		241-245	7000 K
		246-250	7500 K
		251-255	8000 K
20	Macro color	0-9	No function
		10-19	Macro color 1
		20-29	Macro color 2
	 (10in 1)
		190-199	Macro color 19
		200-255	Macro color 20
21	Pattern	0-9	No function
		10-19	Static pattern 1
		20-29	Static pattern 2
	 (10in 1)
		60-69	Static pattern 6
		70-79	Dynamic pattern 1
		80-89	Dynamic pattern 2
	 (10in 1)
		170-179	Dynamic pattern 11
		180-255	Dynamic pattern 12
22	Dynamic pattern Speed (with 21 channel)	0--9	No function
		10--132	Forward, from fast to slow
		133--255	Reverse direction, from slow to fast
23	Dynamic pattern fade	0-255	Pattern effect fade
24	Background dimming	0-255	Background 0-100% dimming
25	Background Strobe	0-255	Background Strobe

CH	Function	DMX Value	Description
26	Pattern Background R	0-255	Pattern effect Red
27	Pattern Background G	0-255	Pattern effect Green
28	Pattern Background B	0-255	Pattern effect Blue
29	Pattern Background W	0-255	Pattern effect White
30	Function	0-137	No Function
		138-149	PWM output frequency 1K-64K (stay for 3 seconds) 1K, 2K, 4K, 6K, 8K, 10K, 16K, 20K, 24K, 32K, 48K, 64K
		150-159	Fast dimming
		160-169	Slow dimming (From fast to slow)
		170-250	No Function
		251-255	Reset (stay for 3 seconds)

► 12CH Mode

CH	Function	DMX Value	Description
1	Pan	0-255	Pan adjustment
2	Pan adjustment	0-255	Pan fine adjustment
3	Tilt	0-255	Tilt adjustment
4	Tilt adjustment	0-255	Tilt fine adjustment
5	Pan/Tilt speed	0-255	from fast to slow
6	Zoom	0-255	From narrow to wide
7	Function	0-137	No Function
		138-149	PWM output frequency 1K-64K (stay for 3 seconds) 1K, 2K, 4K, 6K,

			8K, 10K, 16K, 20K, 24K, 32K, 48K, 64K
		150-159	Fast dimming
		160-169	Slow dimming (From fast to slow)
		170-250	No Function
		251-255	Reset (stay for 3 seconds)
8	dimming curve	0-49	Linear dimming
		50-99	Square rate dimming
		100-149	Inverse square rate dimming
		150-255	S curve dimming
9	Dimmer	0-255	From dark to bright
10	Dimmer adjustment	0-255	From dark to bright
11	Strobe	0-3	Strobe dimming
		4-203	Synchronous strobe speed from slow to fast (1Hz-25Hz)
		204-255	Random Strobe
ArtNet Control			
1	R 1 LED dimming	0-255	R 1 LED dimming
2	G 1 LED dimming	0-255	G 1 LED dimming
3	B 1 LED dimming	0-255	B 1 LED dimming
4	W 1 LED dimming	0-255	W 1 LED dimming
5	R 2 LED dimming	0-255	R 2 LED dimming
6	G 2 LED dimming	0-255	G 2 LED dimming
7	B 2 LED dimming	0-255	B 2 LED dimming
8	W 2 LED dimming	0-255	W 2 LED dimming
9	R 3 LED	0-255	R 3 LED dimming

	dimming		
10	G 3 LED dimming	0-255	G 3 LED dimming
11	B 3 LED dimming	0-255	B 3 LED dimming
12	W 3 LED dimming	0-255	W 3 LED dimming

8. Mounting

When installing the unit, the trussing or area of installation must be able to hold 10 times the weight without any deformation. When installing the unit must be secured with a secondary safety attachment, e.g. an appropriate safety cable. Never stand directly under the facility while mounting, uninstalling or repairing facilities.

High-altitude mounting requires for extensive experience, including working load limits calculating , installation material, and periodic safety check of installation materials and facilities. If you're lack of mentioned qualifications, do not attempt the installation yourself. These installation should be checked by a skilled person annually.

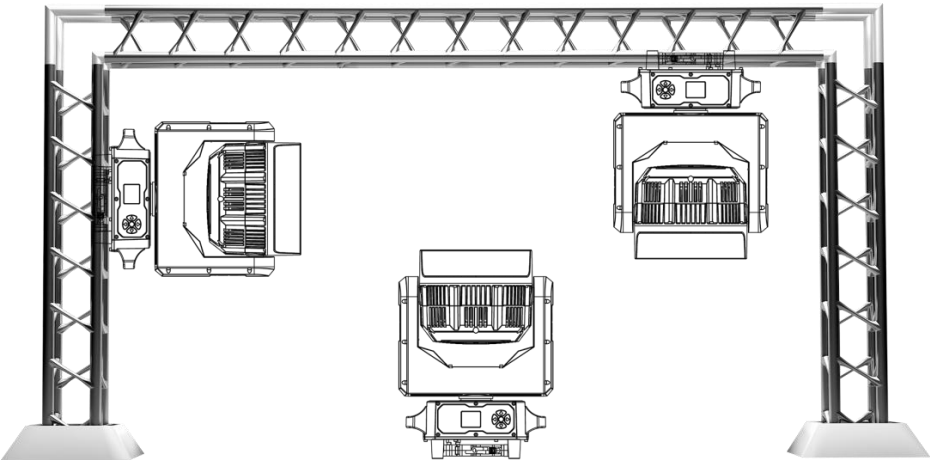

1940ZW works properly in above different mounting, hanging upside-down from a ceiling, sideways on trussing, or set on smooth horizontal surface. Be sure this facility is at least 12m (40ft) away from flammable materials (decoration etc.). Always use and install the safety cable to prevent accidental damage or injury from the facility failure. Never use handles for secondary attachment.

NOTICE: The suitable environment temperature of the facility is from -25° C to 45° C. Do not place this facility in an environment where the temperatures are under or above the temperatures stated. This will help the fixture run at its best and extend the lifetime.

9. Product Size

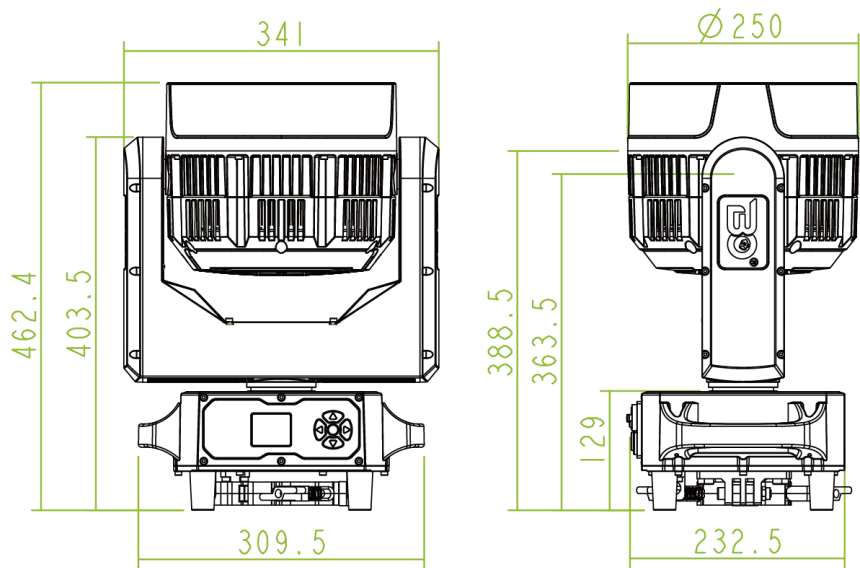

10. Attention

1. When the facility is powered on, please avoid looking directly at the facility.
2. When assembling/ replacing LED, be sure to cut off the main power of facilities before opening the cover upon the LED board.

11. Trouble Shooting

Following are a few common problems that may occur during operation. Here are some suggestions for easy troubleshooting:

A. The unit does not work, no light and the fan does not work

1. Check the status of power connection and fuse.
2. Check the voltage.
3. Check the power indicator.

B. No response to DMX controller

1. If the display screen flashes, check the DMX signal connector and signal line whether the connection is correct.
1. If the display screen does not flash, but no response to channel control, check whether the address code or channel setting is correct.
1. If the DMX signal transmission is intermittent, check if the XLR and DMX cables are in good condition.
2. Try using another controller.
3. Check if the DMX cables is too close to the high-voltage wire, which may damage or interfere with the signal circuit.
6. The facility has not completed the self-check.

C. One of the channels is not working well

1. The stepper motor might be damaged or the cable connected to the PCB is broken.
2. The motor's drive IC on the PCB might be out of condition.

12. Fixture Cleaning

The lens and diffuser should be clean frequently to get better light effect. Wipe frequency according to the environment. Humidity, excessive smoke, and dirty environment will make lens dusty.

- Use soft cloth and special glass cleaner.
- Wipe lens surface at least every 30 days.
- Use vacuum cleaners or air guns to clean the interior structure of the facility, at least twice a year.



Warning:

To avoid the danger of lighting strikes and fire, please do not place the facility in a humid environment. Do not disassemble it without permission, otherwise, the manufacturer will not provide warranty. If the facility fails, please contact the manufacturer first.

Product Warranty Card

Product: IP65 19x40W MINI Wash Zoom

Model NO.: 1940Z MINI IP

Manufacture Date:

User:

Purchase Date:

Manufacturer:

Sales Store:

Address:

ATTN.:

ATTN.:

Phone:

Phone:

Note: The above blank must be filled in and sealed by the end user or sales point, otherwise no warranty will be provided. (Below please check the warranty period and terms)

Warranty Period: This facility is warranted for 2 years from the date of purchase.

Warranty Terms:

1. Except for man-made damage and natural disasters
2. If the facility fails to function properly during the warranty period, please contact our after service department or our local distributor directly.
 - 1) Fail to present a valid warranty card.
 - 2) Omissions, alterations, and trade sales names on the warranty card.
 - 3) Failures and damage caused by force majeure.
 - 4) Failures and damage caused during transportation and handling.
 - 5) Failures and damage caused by failure to follow the instructions for use.
 - 6) Failures and damage caused by disassembly, repair, and modification of the product without the manufacturer's authorization or by non-professionals.
 - 7) Failures caused by the use of accessories not approved by the factory or not matched by the factory.

▲ Thank you for reading this manual. Please keep it for future reference.