

# S2600

## IP65 Thunderbolt Strobe & Beam

---

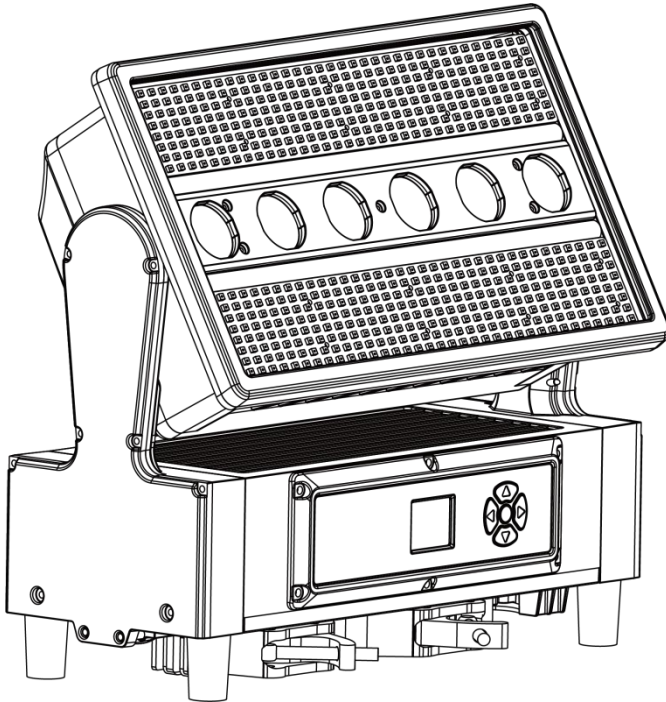

User Manual  
Please read manual carefully before use

## CONTENTS

1. Safety Instructions .....	3
2. Technical Specification .....	5
3. DMX Set Up .....	6
4. Display .....	7
5. Menu .....	8
6. LUX Data .....	12
7. DMX Channel List .....	13
8. Mounting .....	30
9. Product Size .....	31
10. Attention .....	31
11. Trouble Shooting .....	32
A. The unit does not work, no light and the fan does not work .....	32
B. No response to DMX controller .....	32
C. One of the channels is not working well .....	32
12. Fixture Cleaning .....	33

Thank you for choosing our LED lights. Each facility has been rigorously tested. Please check whether the facility has been damaged during transportation. If you find any parts are missing or broken, please contact the manufacturer immediately. Please do not return the product without any notice!

# 1.Safety Instructions



Please read this manual carefully, which includes important information on installation, use and maintenance.

## Attention

- Please keep this USER MANUAL for future consultation. If you sell the facility to another user, be sure that they also receive this USER MANUAL.
- Please open and check in details and make sure there is no transportation damage.
- Before operating, ensure that the voltage and frequency of power supply match the power requirements of the facility.
- It's important to ground the yellow/green conductor to earth in order to avoid electric shock.
- The facility must be installed in a location with adequate ventilation, at least 50 cm from adjacent surfaces. Be sure that no ventilation slots are blocked.
- Make sure the power is disconnected before removing the facility.
- Make sure there are no flammable materials close to the unit while operating as it is fire hazard.
- Use safety cable when fixes this facility. Do not handle the facility by taking its head only, but always by taking its base.
- Maximum ambient temperature is 40 °C . Do not operate it where the temperature is higher than this.
- Please stop using the facility for serious operating problems. Stop using the facility immediately. Never try to repair the facility by yourself, but be a professional technician. Please contact the supplier's service department

for technical support.

- Do not touch any wire during operation as high voltage might be causing electric shock.
- When the housing or lens is damaged, it must be replaced.
- Direct sunlight or any other strong light source penetrating the lens of the light will cause serious internal damage to the facility. During unpacking, installation, use and long-term outdoor idleness, it is forbidden to expose the lens of the facility to direct sunlight or any other strong light source at any angle. It is forbidden to aim the beam of one light directly at another light.

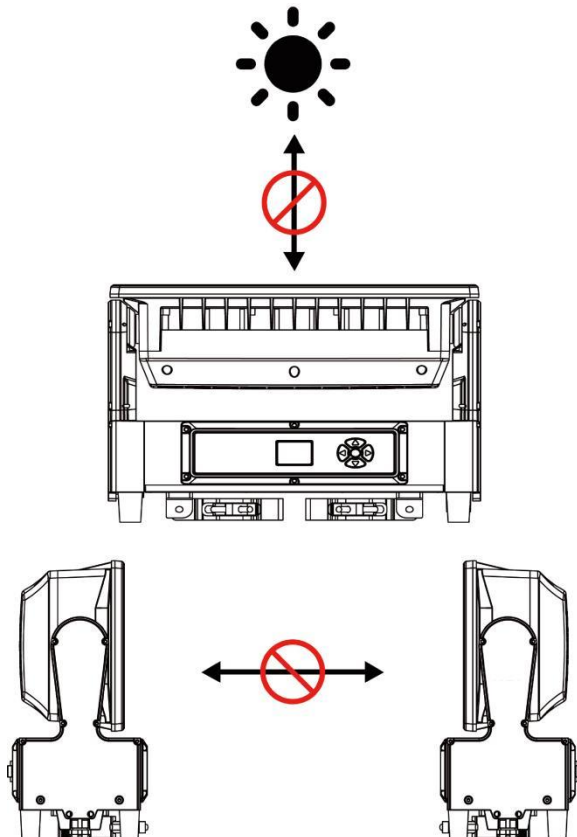

## Caution

There are no accessories available, do not open the housing and try to repair the facilities yourself. Please contact our company for after service.

## Installation

The unit should be mounted via its screw holes on the bracket. Always ensure that the unit is firmly fixed to avoid vibration and slipping while operating. And make sure that the structure to which you are attaching the unit is secure and is able to support a weight of 10 times of the unit's weight. Also always use a safety cable that can hold 12 times of the weight of the unit when installing the fixture.

The facility must be installed by professionals, and keep it far away from fire, walking road, and easy touched place.

## 2. Technical Specification

Light Source	720*1W RGBW ELD (12 section background) 96*10W White LED (Strobe Effect) 6*40W Amber LED (Beam 4.5°)
LED Lifetime	≥ 50000H
Power Voltage	AC100-240V, 50-60Hz
Power Consumption	735W±5%,Power factor PF≥0.95
Beam Angle	4.5°
Control Modes	DMX512/ Auto/ Sound/ Master/ Manual/ RDM/ ArtNet (optional)
DMX Channel	13/15/19/30/34/40 Six master control modes 26/47/77/79 Four pixel modes; 11+36/11+66/13+66 Three DMX ArtNet pixel modes
Protection Rating	IP65
Display	1.8" TFT reversible Display, EN/ CN, The font can be displayed rotated 180°.
Data In/Out Socket	3-pin / 5-pin XLR sockets

Power Socket	Power-Con in/ out		
Housing Material	Die-cast aluminum		
Tilt	190°accuracy 0.86°/step, fine-tuning accuracy: 0.0034°		
Pan/Tilt Resolution	Automatically correct pan/tilt position		
MAX. Connection	4 units (240V, 50Hz)	2.5mm <sup>2</sup>	power cable
	2 units (100V, 60Hz)	2.5mm <sup>2</sup>	power cable
Dimension	427mm*238mm*333mm		
Net Weight	16 kg		
Carton Package	515mm*420mm*325mm	1in1	GW: 19 kg
Flight Case	950mm*625mm*595mm	4in1	GW: 98 kg
Features	Full light range dimming, 16Bit dimming accuracy; fast strobe 1~25Hz; 720*1W LED are divided into 12 segments, 96*10W LED are divided into 12 segments, and 6*40W LED are single-point control; preset multiple color macro functions; preset multiple effect (Wash, single control, segment control, strobe) macro functions; effect mirroring options;		
Configuration	Signal cable	1pc	
	Power cable	1pc	
	Manual	1pc	

### 3. DMX Set Up

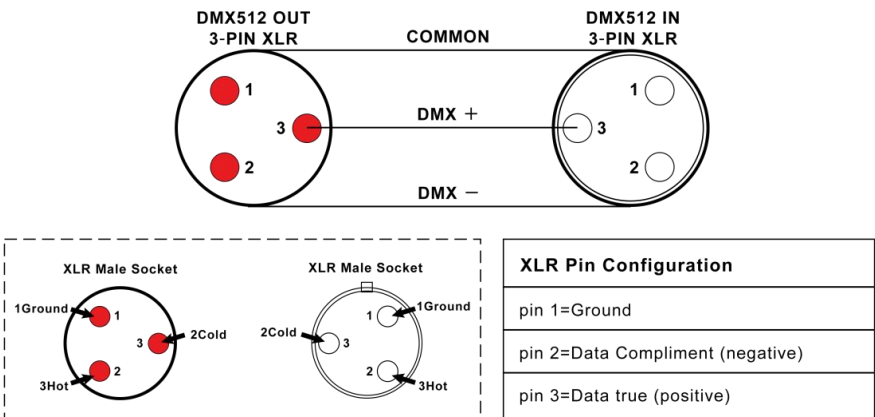

**Pin1: Ground**

**pin2: Negative**

**pin3: Positive**

### DMX Connection

To ensure optimal transmission of DMX data, please connect facilities in the shortest way. The connection order won't affect the DMX address code. For example, if the address code is set to 1, no matter where the facility is connected, its address code will not change. This is determined by the principle of the DMX controller.

### Operation method

You can operate in the following three modes:

- Auto mode - the light can automatically complete all color changes
- DMX control mode - each light can be individually controlled by a standard DMX512 console
- Master mode - any light can work as a host in any of the above modes, and the other lights will work synchronously as slaves

## 4. Display

There are five buttons on the LED panel: ESC, UP, DOWN, ENTER and SAVE.

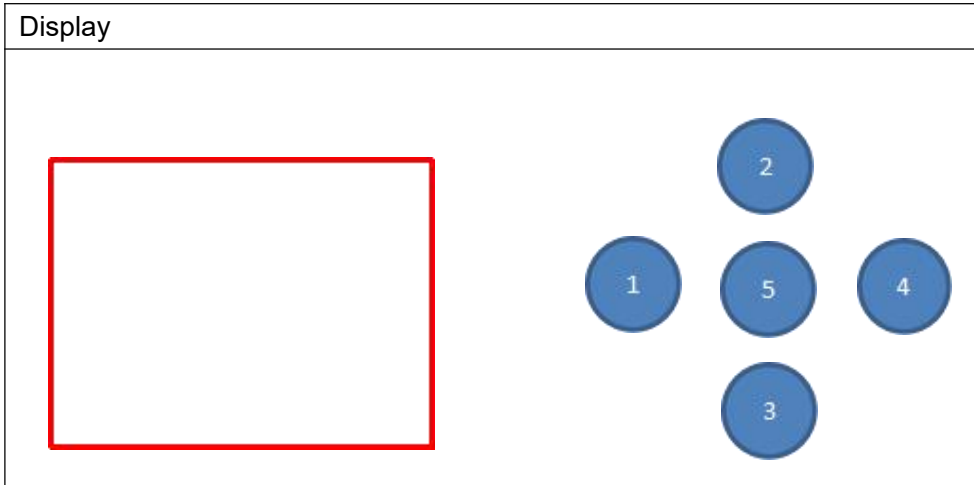

1-ESC    2-UP    3-DOWN    4-ENTER    5-SAVE

1. Return to the previous menu; 2. Up or +; 3. Down or -; 4. Enter the next-level menu; 5. Save and return to the previous menu.

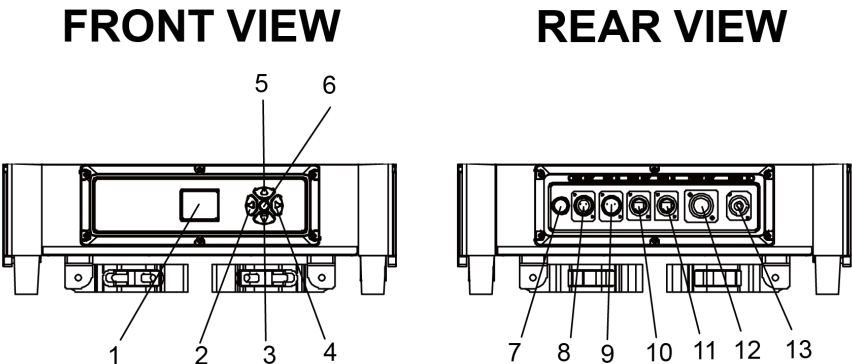

After powering on, the facility will automatically return to the last operation when it was powered off, then get into standby status. For more details, please refer to the information below↓

## 5. Menu

Menu	1.Pan Degree	1.540    2.360	Pan running angle selection
	2.Mic Sense	001-100	Sound control sensitivity adjustment
	3.Language	1.English	
		2.Chinese	
	4.No Signal	1.Black Out    2.Hold	
	5.Fan Set	1.Auto    2.Low 3.High	
	6.Dimmer Mode	1.Mode 1	Dimming mode selection
		2.Mode 2	
		3.Mode 3	
		4.Mode 4	
		5.Mode 5	



	Gamma Curve	1.Gamma 2.0	
		2.Gamma 2.2	
		3.Gamma 2.4	
		4.Gamma 2.6	
	8.Art Net Set	1.Art Net Enable: 1.ON 2.OFF	
		2.Universe:0-255	
		3.IP Mode: A.2.X.X.X Auto B.10.X.X.X Auto C. Customer	
		4.Custom IP:192.168.000.001	
		5.Sub Net Mask: 255.000.000.000	
	9.Reset	1.Yes	Reset
		2.No	
	10.Default	1.Yes	Restore factory settings
		2.No	
	11.Adjust	Password: ****	Changing the value of Tilt can correct the angle; changing the value of R/G/B/W can adjust the white balance
		1.Tilt:0-255	
		2.Red 1: 0-255	
		3.Green 1: 0-255	
		4.Blue 1: 0-255	
		5.White 1: 0-255	
		6.Red 2: 0-255	
		7.Green 2: 0-255	
		8.Blue 2: 0-255	
		9.White 2: 0-255	
Address	001-512		Set the address code from 001 to 512
Reverse	1.Tilt	1.YES      2.NO	
	2.Display	1.YES      2.NO	
	3.Pixel	1.YES      2.NO	

Information	1.CH Value			Display all channel information
	2.Temperature ℃			Display LED board temperature
	3.Version			Program version number
	4.IP	IP 002.018.016.085		Default IP
	5.Mask	Mask 255.000.000.000		Default submask
	6.Use time			Show the using time
	7.Clear time			
Mode	1.DMX 512			Setting the control mode
	2.Auto	1.Master	2.Alone	
	3.Sound	1.Master	2.Alone	
	4.Manual	1.Ma ster 2.Alo ne	1.Tilt:0-255	Manual Control
			2.Red 1: 0-255	
			3.Green 1: 0-255	
			4.Blue 1: 0-255	
			5.White 1: 0-255	
			6.Led 1 Auto: 0-255	
			7.Led 1 Auto Speed: 0-255	
			8.Red 2: 0-255	
			9.Green 2: 0-255	
			10.Blue 2: 0-255	
			11.White 2: 0-255	
12.Led 2 Auto: 0-255				
13.Led 2 Auto Speed: 0-255				

			14.CW	
			15.CW Auto: 0-255	
			16.CW Auto Speed: 0-255	
			17.Strobe: 0-255	
Chan nel	1. 13Channels	Master Mode	Channel mode	
	2. 15Channels			
	3.19Channels			
	4.30Channels			
	5.34Channels			
	6.40Channels			
	7.A26Channels	DMX Pixel Mode		
	8.A47Channels			
	9.A77Channels			
	10.A79Channels			
	11.B47Channels	DXM+ArNet Pixel Mode		
	12.B77Channels			
	13.B79Channels			

## 6. LUX Data

Beam Angle = 4.5°  
 Middle LED:(6\*40W)

L lux	137700	15300	5508	2810	1337
-------	--------	-------	------	------	------

Middle LED:(96\*10W)

W lux	15930	1770	637	325	159
-------	-------	------	-----	-----	-----

Both sides LED:(720\*1W)

R lux	1530	170	61	31	15
G lux	3195	355	128	65	32
B lux	541.8	60.2	21.7	11.1	5.4
W lux	4068	452	163	83	41
4in1 lux	3555	395	142	73	36

FULL15570017300622831781557

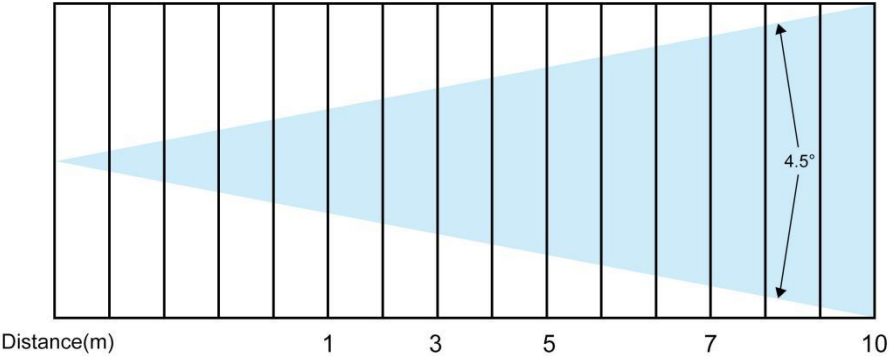

# 7. DMX Channel List

## ► Pixel definition

<b>A77</b> Channel mode <b>A79</b> Channel mode	S1	S2	S3	S4	S5	S6
	CW1	CW2	CW3	CW4	CW5	CW6
	M1	M2	M3	M4	M5	M6
	CW7	CW8	CW9	CW10	CW11	CW12
	S7	S8	S9	S10	S11	S12

A26Channel mode	S1	S2	S3
	CW1 CW2	CW2	CW3
	M1	M2	M3
	CW1 CW2	CW2	CW3
	S1	S2	S3

<b>A47</b> Chan nel mode <b>B47</b> Chan nel mode	S1	S2	S3	S4	S5	S6
	CW1	CW2	CW3	CW4	CW5	CW6
	M1	M2	M3	M4	M5	M6
	CW1	CW2	CW3	CW4	CW5	CW6

	S1	S2	S3	S4	S5	S6
--	----	----	----	----	----	----

## ► Master Mode

DMX512 signal control or ArtNet signal control								
CH						Function	DMX Value	Description
13 ch	15 ch	19 ch	30 ch	34 ch	40 ch			
1	1	1	1	1	1	Tilt	0-255	Tilt control
2	2	2	2	2	2	Tilt adjust	0-255	Tilt adjust control
3	3	3	3	3	3	Tilt speed	0-255	Speed from fast to slow
4	4	4	4	4	4	Function Channels	To activate the following functions, hold the DMX value for at least 3s	
							0-29	Reserved
							30-39	Dimmer Curve Gamma2.0
							40-49	Dimmer Curve Gamma2.2
							50-59	Dimmer Curve Gamma2.4
							60-69	Dimmer Curve Gamma2.6
							70-89	Reserved
							90-99	Dimmer Mode Off
							100-109	Dimmer Mode 1
							110-119	Dimmer Mode 2
							120-129	Dimmer Mode 3
							130-139	Dimmer Mode 4
							140-159	Reserved
							160-169	Pixel Inversion: No
							170-179	Pixel Inversion: Yes
							180-250	Reserved
							251-255	Reset

5	5		5			Dimmer	0-255	Dim from dark to bright
6	6		6			Dimmer adjustment	0-255	adjust dimming
		5		5	5	Main light dimming	0-255	Dim from dark to bright
		6		6	6	Main light dimming adjustment	0-255	adjust dimming
7						strobe	000-003	Strobe dimming
							004-203	Synchronous strobe speed from slow to fast (1Hz-25Hz)
							204-255	Random strobe
	7	7	7	7	7	Main light strobe	000-003	Strobe dimming
							004-203	Synchronous strobe speed from slow to fast (1Hz-25Hz)
							204-255	Random strobe
		8		8	8	Strobe light dimming	0-255	from dark to bright
		9		9	9	Strobe light dimming adjustment	0-255	dimming adjustment
	8	10	8	10	10	Strobe light strobe	000-003	Strobe dimming
							004-203	Synchronous strobe speed from slow to fast (1Hz-25Hz)
							204-255	Random strobe
		11		11	11	Strobe bar dimming	0-255	from dark to bright
		12		12	12	Strobe bar dimming adjustment	0-255	dimming adjustment
	9	13	9	13	13	Strobe bar strobe	000-003	Strobe dimming
							004-203	Synchronous strobe speed from slow to fast (1Hz-25Hz)
							204-255	Random strobe

8	10	14	10	14	14	Main Light Amber	0-255	White dimming
			11	15	15		0-9	No function
							10-14	Effect 1
							15-19	Effect 2
							20-24	Effect 3
							25-29	Effect 4
							30-34	Effect 5
							35-39	Effect 6
							40-44	Effect 7
							45-49	Effect 8
							50-54	Effect 9
							55-59	Effect 10
							60-64	Effect 11
							65-69	Effect 12
							70-74	Effect 13
							75-79	Effect 14
							80-84	Effect 15
							85-89	Effect 16
							90-94	Effect 17
							95-99	Effect 18
							100-255	reserved
			12	16	16	Main light effect pan	0-255	Select built-in effect scene shift
			13	17	17	Main light effect speed	0-9	No function
							10-132	Forward, from fast to slow
							133-255	Reverse, from slow to fast
			14	18	18	Main light effect fade	0-255	Effect fade in and out
9	11	15	15	19	19	Strobe light red	0-255	Red dimming



10	12	16	16	20	20	Strobe light green	0-255	Green dimming
11	13	17	17	21	21	Strobe light blue	0-255	Blue dimming
12	14	18	18	22	22	Strobe light white	0-255	White dimming
			19	23	23	Strobe light color temperature	0-4	No function
							5-255	Color temperature from warm to cold
			20	24	24	Strobe light macro color	0-9	No function
							10-255	Macro color
			21	25	25	Strobe built-in effects	Color selection is required during performance. The color is selected from the front color channel, and the background color is selected from the background macro color or background color channel of the back strobe light effect.	
							0-9	No function
							10-14	Effect 1
							15-19	Effect 2
							20-24	Effect 3
							25-29	Effect 4
							30-34	Effect 5
							35-39	Effect 6
							40-44	Effect 7
							45-49	Effect 8
							50-54	Effect 9
							55-59	Effect 10
							60-64	Effect 11
							65-69	Effect 12
							70-74	Effect 13
							75-79	Effect 14
							80-84	Effect 15

							85-89	Effect 16
							90-94	Effect 17
							95-99	Effect 18
							100-104	Effect 19
							105-109	Effect 20
							110-114	Effect 21
							115-119	Effect 22
							120-124	Effect 23
							125-129	Effect 24
							130-255	reserved
			22	26	26	Strobe effect pan	0-255	Select built-in effect scene shift
							0-9	No function
			23	27	27	Strobe effect speed	10-132	Forward, from fast to slow
							133-255	Reverse, from slow to fast
			24	28	28	Strobe effect fade	0-255	Effect fade in and out
					29	Strobe effect background total dimming	0-255	Background 0-100% dimming
							000-003	Strobe dimming
					30	Strobe effect background strobe	004-203	Synchronous strobe speed from slow to fast (1Hz-25Hz)
							204-255	Random strobe
			25	29	31	Strobe effect background macro color	0-9	No function
							10-255	Macro color
					32	Strobe light effect background red	0-255	Effect background red
					33	Strobe light effect	0-255	Effect background green

						background green		
					34	Strobe light effect background blue	0-255	Effect background blue
					35	Strobe light effect background white	0-255	Effect background white
13	15	19	26	30	36	Strobe bar cold white	0-255	Cold white dimming
			27	31	37	Strobe bar built-in effect	Color selection is required during performance. The color is selected from the front color channel, and the background color is selected from the background macro color or background color channel of the back strobe light effect.	
							0-9	No function
							10-14	Effect 1
							15-19	Effect 2
							20-24	Effect 3
							25-29	Effect 4
							30-34	Effect 5
							35-39	Effect 6
							40-44	Effect 7
							45-49	Effect 8
							50-54	Effect 9
							55-59	Effect 10
							60-64	Effect 11
							65-69	Effect 12
							70-74	Effect 13
							75-79	Effect 14
							80-84	Effect 15

							85-89	Effect 16
							90-94	Effect 17
							95-99	Effect 18
							100-104	Effect 19
							105-109	Effect 20
							110-114	Effect 21
							115-119	Effect 22
							120-124	Effect 23
							125-129	Effect 24
							130-255	Reserved
			28	32	38	Strobe bar effect panning	0-255	Select built-in effect scene translation
			29	33	39	Strobe bar effect speed	0-9	No function
							10-132	Forward, from fast to slow
							133-255	Reverse, from slow to fast
			30	34	40	Strobe bar effect fade	0-255	Effect fade in and out

## ► DMX Pixel Mode

DMX512 signal control or ArtNet signal control						
CH				Function	DMX Value	Description
26 ch	47 ch	77 ch	79 ch			
1	1	1	1	Tilt	0-255	Tilt control
2	2	2	2	Tilt adjust	0-255	Tilt adjust control
3	3	3	3	Tilt speed	0-255	Speed from fast to slow
4	4	4	4	Function Channels	To activate the following functions, hold the DMX value for at least 3s	
					0-29	Reserved

					30-39	Dimmer Curve Gamma2.0
					40-49	Dimmer Curve Gamma2.2
					50-59	Dimmer Curve Gamma2.4
					60-69	Dimmer Curve Gamma2.6
					70-89	Reserved
					90-99	Dimmer Mode Off
					100-109	Dimmer Mode 1
					110-119	Dimmer Mode 2
					120-129	Dimmer Mode 3
					130-139	Dimmer Mode 4
					140-159	Reserved
					160-169	Pixel Inversion: No
					170-179	Pixel Inversion: Yes
					180-250	Reserved
					251-255	Reset
5	5	5		Dimmer	0--255	Dim from dark to bright
			5	Main light dimming	0-255	Dim from dark to bright
			6	Strobe light dimming	0--255	from dark to bright
			7	Strobe bar dimming	0--255	from dark to bright
6	6	6	8	Main light strobe	000-003	Strobe dimming
					004--20 3	Synchronous strobe speed from slow to fast (1Hz-25Hz)
					204--25 5	Random strobe
7	7	7	9	Strobe light strobe	000-003	Strobe dimming
					004--20 3	Synchronous strobe speed from slow to fast (1Hz-25Hz)

					204--25 5	Random strobe
8	8	8	10	Strobe bar strobe	000-003	Strobe dimming
					004--20 3	Synchronous strobe speed from slow to fast (1Hz-25Hz)
					204--25 5	Random strobe
	9	9	11	Main light effect fade	0-255	Effect fade in and out
	10	10	12	Strobe light effect fade	0-255	Effect fade in and out
	11	11	13	Strobe bar effect fade	0-255	Effect fade in and out
9	12	12	14	Main Light Amber 1	0-255	White Dimming
10	13	13	15	Main Light Amber 2	0-255	White Dimming
11	14	14	16	Main Light Amber 3	0-255	White Dimming
	15	15	17	Main Light Amber 4	0-255	White Dimming
	16	16	18	Main Light Amber 5	0-255	White Dimming
	17	17	19	Main Light Amber 6	0-255	White Dimming
12	18	18	20	Strobe Light Red 1	0-255	Red Dimming
13	19	19	21	Strobe Light Green 1	0-255	Green Dimming
14	20	20	22	Strobe Light Blue 1	0-255	Blue Dimming
15	21	21	23	Strobe Light white 1	0-255	White Dimming
16	22	22	24	Strobe Light Red 2	0--255	Red Dimming
17	23	23	25	Strobe Light Green 2	0--255	Green Dimming
18	24	24	26	Strobe Light Blue 2	0--255	Blue Dimming
19	25	25	27	Strobe Light White 2	0--255	White Dimming

20	26	26	28	Strobe Light Red 3	0--255	Red Dimming
21	27	27	29	Strobe Light Green 3	0--255	Green Dimming
22	28	28	30	Strobe Light Blue 3	0--255	Blue Dimming
23	29	29	31	Strobe Light White 3	0--255	White Dimming
	30	30	32	Strobe Light Red 4	0--255	Red Dimming
	31	31	33	Strobe Light Green 4	0--255	Green Dimming
	32	32	34	Strobe Light Blue 4	0--255	Blue Dimming
	33	33	35	Strobe Light White 4	0--255	White Dimming
	34	34	36	Strobe Light Red 5	0--255	Red Dimming
	35	35	37	Strobe Light Green 5	0--255	Green Dimming
	36	36	38	Strobe Light Blue 5	0--255	Blue Dimming
	37	37	39	Strobe Light White 5	0--255	White Dimming
	38	38	40	Strobe Light Red 6	0--255	Red Dimming
	39	39	41	Strobe Light Green 6	0--255	Green Dimming
	40	40	42	Strobe Light Blue 6	0--255	Blue Dimming
	41	41	43	Strobe Light White 6	0--255	White Dimming
		42	44	Strobe Light Red 7	0--255	Red Dimming
		43	45	Strobe Light Green 7	0--255	Green Dimming
		44	46	Strobe Light Blue 7	0--255	Blue Dimming
		45	47	Strobe Light White 7	0--255	White Dimming
		46	48	Strobe Light Red 8	0--255	Red Dimming

		47	49	Strobe Light Green 8	0--255	Green Dimming
		48	50	Strobe Light Blue 8	0--255	Blue Dimming
		49	51	Strobe Light White 8	0--255	White Dimming
		50	52	Strobe Light Red 9	0--255	Red Dimming
		51	53	Strobe Light Green 9	0--255	Green Dimming
		52	54	Strobe Light Blue 9	0--255	Blue Dimming
		53	55	Strobe Light White 9	0--255	White Dimming
		54	56	Strobe Light Red 10	0--255	Red Dimming
		55	57	Strobe Light Green 10	0--255	Green Dimming
		56	58	Strobe Light Blue 10	0--255	Blue Dimming
		57	59	Strobe Light White 10	0--255	White Dimming
		58	60	Strobe Light Red 11	0--255	Red Dimming
		59	61	Strobe Light Green 11	0--255	Green Dimming
		60	62	Strobe Light Blue 11	0--255	Blue Dimming
		61	63	Strobe Light White 11	0--255	White Dimming
		62	64	Strobe Light Red 12	0--255	Red Dimming
		63	65	Strobe Light Green 12	0--255	Green Dimming
		64	66	Strobe Light Blue 12	0--255	Blue Dimming
		65	67	Strobe Light White 12	0--255	White Dimming
24	42	66	68	Strobe bar Cold White 1	0--255	Cold White Dimming
25	43	67	69	Strobe bar Cold White 2	0--255	Cold White Dimming



26	44	68	70	Strobe bar Cold White 3	0--255	Cold White Dimming
	45	69	71	Strobe bar Cold White 4	0--255	Cold White Dimming
	46	70	72	Strobe bar Cold White 5	0--255	Cold White Dimming
	47	71	73	Strobe bar Cold White 6	0--255	Cold White Dimming
		72	74	Strobe bar Cold White 7	0--255	Cold White Dimming
		73	75	Strobe bar Cold White 8	0--255	Cold White Dimming
		74	76	Strobe bar Cold White 9	0--255	Cold White Dimming
		75	77	Strobe bar Cold White 10	0--255	Cold White Dimming
		76	78	Strobe bar Cold White 11	0--255	Cold White Dimming
		77	79	Strobe bar Cold White 12	0--255	Cold White Dimming

## ►DXM+ArNet Pixel Mode

Ordinary DMX512 signal control + ArtNet signal control					
Ordinary DMX512 signal control					
CH			Function	DMX Value	Description
11+36 ch	11+66 ch	13+66ch			
1	1	1	Tilt	0-255	Tilt control
2	2	2	Tilt adjust	0-255	Tilt adjust control
3	3	3	Tilt speed	0-255	Speed from fast to slow
4	4	4	Function Channels	To activate the following functions, hold the DMX value for at least 3s	
				0-29	Reserved
				30-39	Dimmer Curve Gamma2.0
				40-49	Dimmer Curve Gamma2.2

				50-59	Dimmer Curve Gamma2.4
				60-69	Dimmer Curve Gamma2.6
				70-89	Reserved
				90-99	Dimmer Mode Off
				100-109	Dimmer Mode 1
				110-119	Dimmer Mode 2
				120-129	Dimmer Mode 3
				130-139	Dimmer Mode 4
				140-159	Reserved
				160-169	Pixel Inversion: No
				170-179	Pixel Inversion: Yes
				180-250	Reserved
				251-255	Reset
5	5		Total dimming	0-255	from dark to bright
		5	Main light dimming	0-255	from dark to bright
		6	Strobe light dimming	0-255	from dark to bright
		7	Strobe strip dimming	0-255	from dark to bright
6	6	8	Main light strobe	0--3	Strobe dimming
				4--203	Synchronous strobe speed from slow to fast (1Hz-25Hz)
				204--255	Random strobe
7	7	9	Strobe light strobe	0--3	Strobe dimming
				4--203	Synchronous strobe speed from slow to fast (1Hz-25Hz)
				204--255	Random strobe

8	8	10	Strobe bar strobe	0--3	Strobe dimming
				4--203	Synchronous strobe speed from slow to fast (1Hz-25Hz)
				204--255	Random strobe
9	9	11	Main light effect fade	0-255	Effect fade in and out
10	10	12	Strobe light effect fade	0-255	Effect fade in and out
11	11	13	Strobe bar effect fade	0-255	Effect fade in and out
<b>ArtNet Signal Control</b>					
1	1	1	Main Light White 1	0--255	White dimming
2	2	2	Main Light White 2	0--255	White dimming
3	3	3	Main Light White 3	0--255	White dimming
4	4	4	Main Light White 4	0--255	White dimming
5	5	5	Main Light White 5	0--255	White dimming
6	6	6	Main Light White 6	0--255	White dimming
7	7	7	Strobe Light Red 1	0--255	Red dimming
8	8	8	Strobe Light Green 1	0--255	Green dimming
9	9	9	Strobe Light Blue 1	0--255	Blue dimming
10	10	10	Strobe Light White 1	0--255	White dimming
11	11	11	Strobe Light Red 2	0--255	Red dimming
12	12	12	Strobe Light Green 2	0--255	Green dimming
13	13	13	Strobe Light Blue 2	0--255	Blue dimming
14	14	14	Strobe Light White 2	0--255	White dimming
15	15	15	Strobe Light Red 3	0--255	Red dimming
16	16	16	Strobe Light Green 3	0--255	Green dimming
17	17	17	Strobe Light Blue 3	0--255	Blue dimming
18	18	18	Strobe Light White 3	0--255	White dimming
19	19	19	Strobe Light Red 4	0--255	Red dimming
20	20	20	Strobe Light Green 4	0--255	Green dimming

21	21	21	Strobe Light Blue 4	0--255	Blue dimming
22	22	22	Strobe Light White 4	0--255	White dimming
23	23	23	Strobe Light Red 5	0--255	Red dimming
24	24	24	Strobe Light Green 5	0--255	Green dimming
25	25	25	Strobe Light Blue 5	0--255	Blue dimming
26	26	26	Strobe Light White 5	0--255	White dimming
27	27	27	Strobe Light Red 6	0--255	Red dimming
28	28	28	Strobe Light Green 6	0--255	Green dimming
29	29	29	Strobe Light Blue 6	0--255	Blue dimming
30	30	30	Strobe Light White 6	0--255	White dimming
	31	31	Strobe Light Red 7	0--255	Red dimming
	32	32	Strobe Light Green 7	0--255	Green dimming
	33	33	Strobe Light Blue 7	0--255	Blue dimming
	34	34	Strobe Light White 7	0--255	White dimming
	35	35	Strobe Light Red 8	0--255	Red dimming
	36	36	Strobe Light Green 8	0--255	Green dimming
	37	37	Strobe Light Blue 8	0--255	Blue dimming
	38	38	Strobe Light White 8	0--255	White dimming
	39	39	Strobe Light Red 9	0--255	Red dimming
	40	40	Strobe Light Green 9	0--255	Green dimming
	41	41	Strobe Light Blue 9	0--255	Blue dimming
	42	42	Strobe Light White 9	0--255	White dimming
	43	43	Strobe Light Red 10	0--255	Red dimming
	44	44	Strobe Light Green 10	0--255	Green dimming
	45	45	Strobe Light Blue 10	0--255	Blue dimming
	46	46	Strobe Light White 10	0--255	White dimming
	47	47	Strobe Light Red 11	0--255	Red dimming
	48	48	Strobe Light Green 11	0--255	Green dimming
	49	49	Strobe Light Blue 11	0--255	Blue dimming

	50	50	Strobe Light White 11	0--255	White dimming
	51	51	Strobe Light Red 12	0--255	Red dimming
	52	52	Strobe Light Green 12	0--255	Green dimming
	53	53	Strobe Light Blue 12	0--255	Blue dimming
	54	54	Strobe Light White 12	0--255	White dimming
31	55	55	Strobe bar cold white 1	0--255	Cold White dimming
32	56	56	Strobe bar cold white 2	0--255	Cold White dimming
33	57	57	Strobe bar cold white 3	0--255	Cold White dimming
34	58	58	Strobe bar cold white 4	0--255	Cold White dimming
35	59	59	Strobe bar cold white 5	0--255	Cold White dimming
36	60	60	Strobe bar cold white 6	0--255	Cold White dimming
	61	61	Strobe bar cold white 7	0--255	Cold White dimming
	62	62	Strobe bar cold white 8	0--255	Cold White dimming
	63	63	Strobe bar cold white 9	0--255	Cold White dimming
	64	64	Strobe bar cold white 10	0--255	Cold White dimming
	65	65	Strobe bar cold white 11	0--255	Cold White dimming
	66	66	Strobe bar cold white 12	0--255	Cold White dimming

## 8. Mounting

When installing the unit, the trussing or area of installation must be able to hold 10 times the weight without any deformation. When installing the unit must be secured with a secondary safety attachment, e.g. an appropriate safety cable. Never stand directly under the facility while mounting, uninstalling or repairing facilities.

High-altitude mounting requires for extensive experience, including working load limits calculating , installation material, and periodic safety check of installation materials and facilities. If you're lack of mentioned qualifications, do not attempt the installation yourself. These installation should be checked by a skilled person annually.

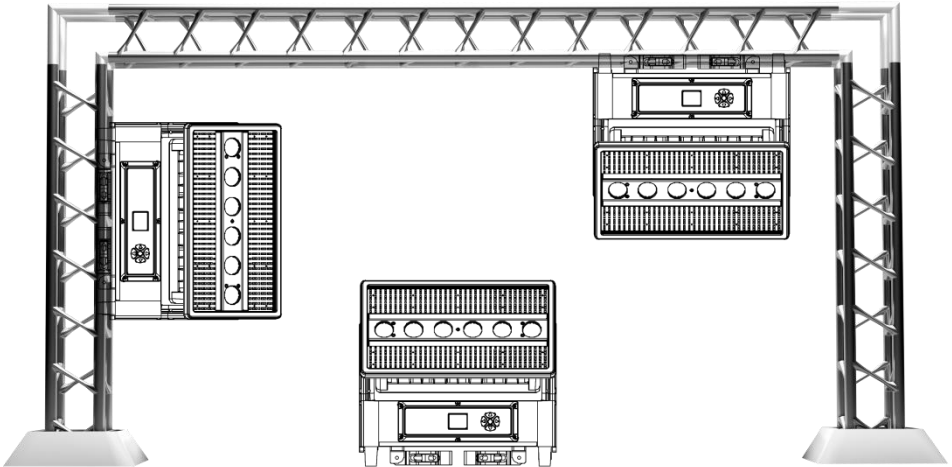

S2600 works properly in above different mounting, hanging upside-down from a ceiling, sideways on trussing, or set on smooth horizontal surface. Be sure this facility is at least 1m (3.5 ft) away from flammable materials (decoration

etc.). Always use and install the safety cable to prevent accidental damage or injury from the facility failure. Never use handles for secondary attachment.

**NOTICE:** The suitable environment temperature of the facility is from -10° C to 45° C. Do not place this facility in an environment where the temperatures are under or above the temperatures stated. This will help the fixture run at its best and extend the lifetime.

## 9. Product Size

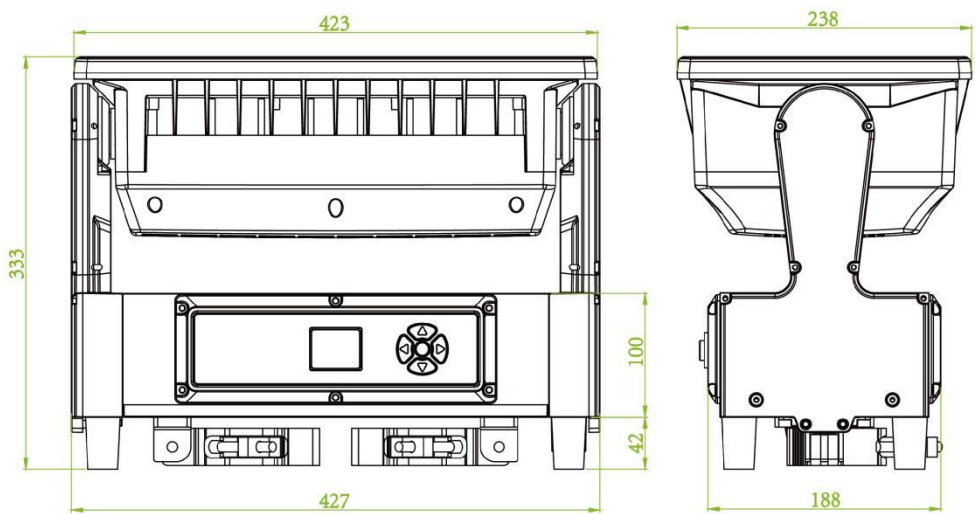

## 10. Attention

1. When the facility is powered on, please avoid looking directly at the facility.
2. When assembling/ replacing LED, be sure to cut off the main power of facilities before opening the cover upon the LED board.

## 11. Trouble Shooting

Following are a few common problems that may occur during operation. Here are some suggestions for easy troubleshooting:

### **A. The unit does not work, no light and the fan does not work**

1. Check the status of power connection and fuse.
2. Check the voltage.
3. Check the power indicator.

### **B. No response to DMX controller**

1. If the display screen flashes, check the DMX signal connector and signal line whether the connection is correct.
1. If the display screen does not flash, but no response to channel control, check whether the address code or channel setting is correct.
1. If the DMX signal transmission is intermittent, check if the XLR and DMX cables are in good condition.
2. Try using another controller.
3. Check if the DMX cables is too close to the high-voltage wire, which may damage or interfere with the signal circuit.
6. The facility has not completed the self-check.

### **C. One of the channels is not working well**

1. The stepper motor might be damaged or the cable connected to the PCB is broken.
2. The motor's drive IC on the PCB might be out of condition.



## 12. Fixture Cleaning

The lens and diffuser should be clean frequently to get better light effect. Wipe frequency according to the environment. Humidity, excessive smoke, and dirty environment will make lens dusty.

- Use soft cloth and special glass cleaner.
- Wipe lens surface at least every 30 days.
- Use vacuum cleaners or air guns to clean the interior structure of the facility, at least twice a year.



Warning:

To avoid the danger of lighting strikes and fire, please do not place the facility in a humid environment. Do not disassemble it without permission, otherwise, the manufacturer will not provide warranty. If the facility fails, please contact the manufacturer first.

## Product Warranty Card

Product: IP65 Thunderbolt Strobe & Beam

Model NO.: S2600

Manufacture Date:

User:

Purchase Date:

Manufacturer:

Sales Store:

Address:

ATTN.:

ATTN.:

Phone:

Phone:

Note: The above blank must be filled in and sealed by the end user or sales point, otherwise no warranty will be provided. (Below please check the warranty period and terms)

Warranty Period: This facility is warranted for 2 years from the date of purchase.

Warranty Terms:

1. Except for man-made damage and natural disasters
2. If the facility fails to function properly during the warranty period, please contact our after service department or our local distributor directly.
  - 1) Fail to present a valid warranty card.
  - 2) Omissions, alterations, and trade sales names on the warranty card.
  - 3) Failures and damage caused by force majeure.
  - 4) Failures and damage caused during transportation and handling.
  - 5) Failures and damage caused by failure to follow the instructions for use.
  - 6) Failures and damage caused by disassembly, repair, and modification of the product without the manufacturer's authorization or by non-professionals.
  - 7) Failures caused by the use of accessories not approved by the factory or not matched by the factory.

▲ Thank you for reading this manual. Please keep it for future reference.