

# 1940ZWR

## IP65 19\*40W Zoom Wash Moving Head

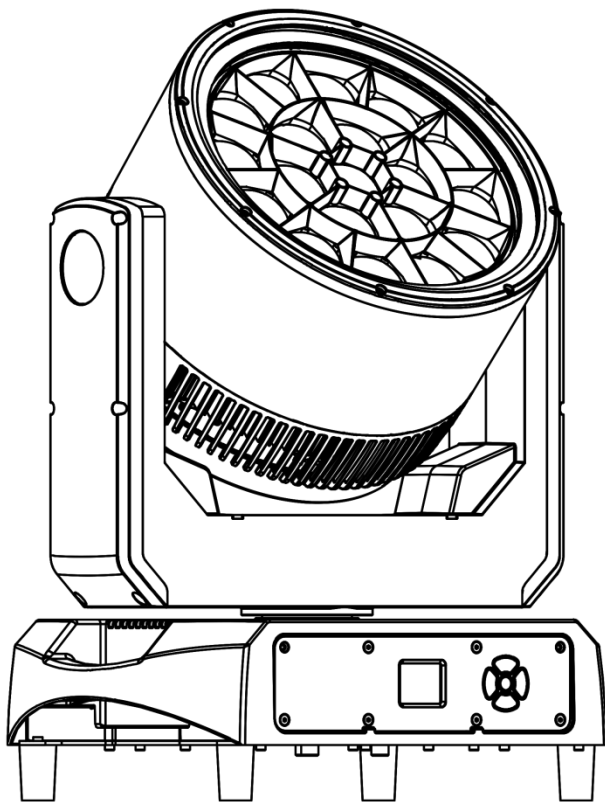

User Manual

---

Please read manual carefully before use

# CONTENTS

1. Safety Instructions .....	3
2. Technical Specification .....	5
3. DMX Set Up .....	7
4. Display .....	8
5. Menu .....	8
6. LUX Data .....	12
7. DMX Channel List .....	12
8. Mounting .....	26
9. Product Size .....	28
10. Attention .....	28
11. Trouble Shooting .....	28
A. The unit does not work, no light and the fan does not work .....	28
B. Not responding to DMX controller .....	29
C. One of the channels is not working well .....	29
12. Fixture Cleaning .....	29

Thank you for choosing our LED lights. Each facility has been rigorously tested. Please check whether the facility has been damaged during transportation. If you find any parts are missing or broken, please contact the manufacturer immediately. Please do not return the product without any notice!

# 1.Safety Instructions



Please read this manual carefully, which includes important information on installation, use and maintenance.

## Attention

- Please keep this USER MANUAL for future consultation. If you sell the facility to another user, be sure that they also receive this USER MANUAL.
- Please open and check in details and make sure there is no transportation damage.
- Before operating, ensure that the voltage and frequency of power supply match the power requirements of the facility.
- It's important to ground the yellow/green conductor to earth in order to avoid electric shock.
- The facility must be installed in a location with adequate ventilation, at least 50 cm from adjacent surfaces. Be sure that no ventilation slots are blocked.
- Make sure the power is disconnected before removing the facility.
- Make sure there are no flammable materials close to the unit while operating as it is fire hazard.
- Use safety cable when fixes this facility. Do not handle the facility by taking its head only, but always by taking its base.
- Maximum ambient temperature is 40 °C . Do not operate it where the temperature is higher than this.
- Please stop using the facility for serious operating problems. Stop using the facility immediately. Never try to repair the facility by yourself, but be a

professional technician. Please contact the supplier's service department for technical support.

- Do not touch any wire during operation as high voltage might be causing electric shock.
- When the housing or lens is damaged, it must be replaced.
- Direct sunlight or any other strong light source penetrating the lens of the light will cause serious internal damage to the facility. During unpacking, installation, use and long-term outdoor idleness, it is forbidden to expose the lens of the facility to direct sunlight or any other strong light source at any angle. It is forbidden to aim the beam of one light directly at another light.

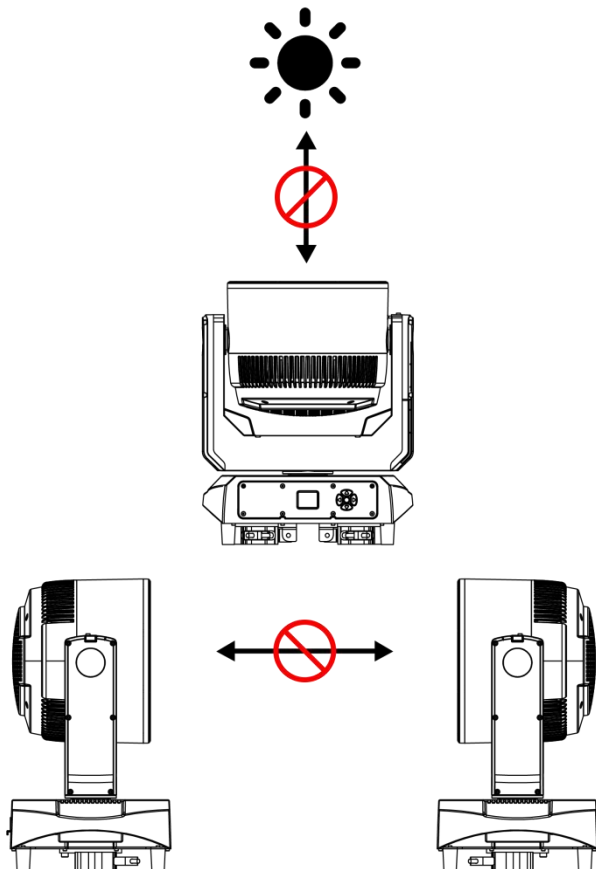

## Caution

There are no accessories available, do not open the housing and try to repair the facilities yourself. Please contact our company for after service.

## Installation

The unit should be mounted via its screw holes on the bracket. Always ensure that the unit is firmly fixed to avoid vibration and slipping while operating. And make sure that the structure to which you are attaching the unit is secure and is able to support a weight of 10 times of the unit's weight. Also always use a safety cable that can hold 12 times of the weight of the unit when installing the fixture.

The facility must be installed by professionals, and keep it far away from fire, walking road, and easy touched place.

## 2. Technical Specification

Light Source	19pcs 40W RGBW 4in1 LED;Ring:72pcs 1W RGBA 4in1 LED
LED Lifetime	≥ 50000H
Power Voltage	AC100-240V , 50-60Hz
Power Consumption	650W±5%,PF≥0.95;Standby power:22.5W
Beam Angle	4.5°-43°
Control Modes	DMX512、Auto、Sound、Manual、RDM、ArtNet(option)
DMX Channel	27/35/45/71/80/76Channels
Protection Rating	IP65
Display	1.8°TFT Color Display,Can be rotated 180°,Chinese and English can be switched

Data In/Out Socket	3-pin XLR sockets
Power Socket	Power-Con in/ out
Housing Material	Aluminum
Working temperature	-10℃~45℃
Pan	540°accuracy 2.11°/step, fine-tuning accuracy: 0.008°
Tilt	270°accuracy 0.86°/step, fine-tuning accuracy: 0.0034°
Photoelectric reset system	Accurately and automatically correct X-axis/Y-axis position
MAX. Connection	4 units (240V) 2.5mm <sup>2</sup> power cable
	2 units (120V) 2.5mm <sup>2</sup> power cable
Net Weight	24.7kg
Dimension	418*319*522mm
Carton Package	645*405*505mm 1in1 GW:28.2kg
Flight Case	845*560*740mm 2in1 GW:85.1kg
Features	Full light range dimming, 65536-level dimming accuracy.Fast strobe 1-25Hz.19pcs 40W led with interval control - 3 circles; the aperture is divided into 12 sections.Preset multiple color macro functions; Preset multiple effect (coloring, circle control, strobe) macro functions
Configuration	Signal cable 1pc
	Power cable 1pc
	Manual 1pc

### 3. DMX Set Up

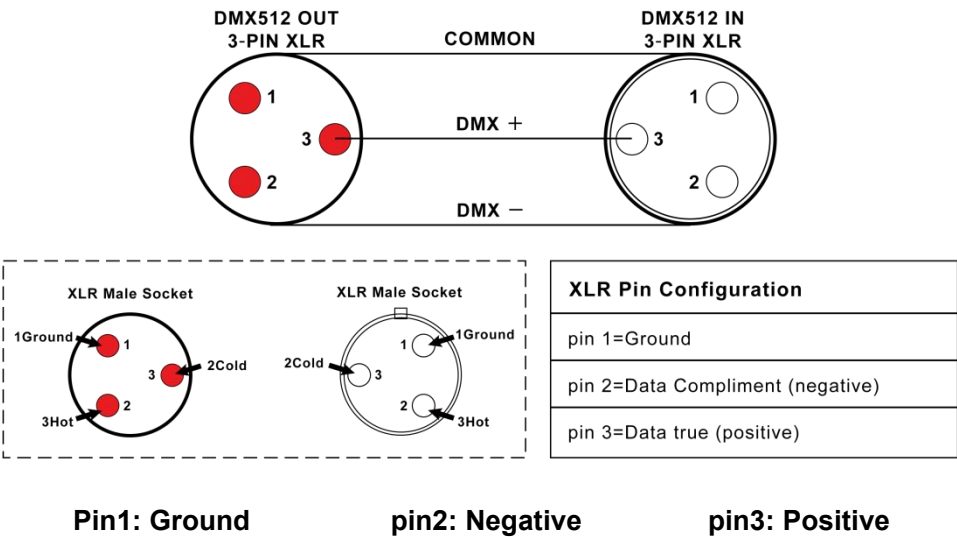

#### DMX Connection

To ensure optimal transmission of DMX data, please connect facilities in the shortest way. The connection order won't affect the DMX address code. For example, if the address code is set to 1, no matter where the facility is connected, its address code will not change. This is determined by the principle of the DMX controller.

#### Operation method

You can operate in the following three modes:

- Auto mode - the light can automatically complete all color changes
- DMX control mode - each light can be individually controlled by a standard DMX512 console
- Master mode - any light can work as a host in any of the above modes, and the other lights will work synchronously as slaves

## 4. Display

There are four buttons on the LED panel: MENU, UP, DOWN, and ENTER.

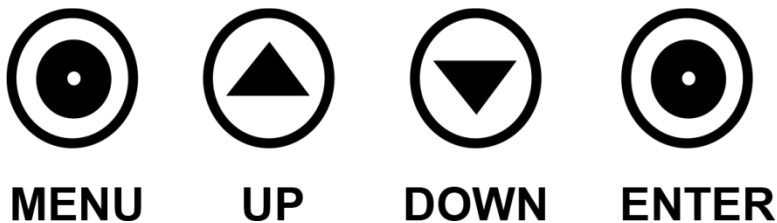

Please press the "MENU" to exit or return to the previous menu, press "UP" or "DOWN" to select the upper and lower menus or adjust the values, and press "ENTER" to confirm.

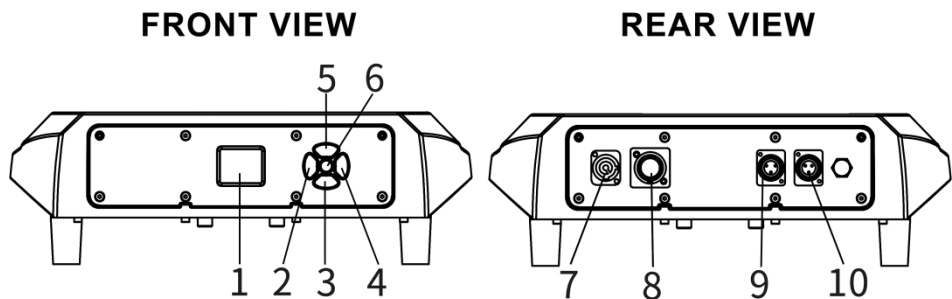

After powering on, the facility will automatically return to the last operation when it was powered off, then get into standby status. For more details, please refer to the information below↓

## 5. Menu

1 previous-MENU   2 UP   3 DOWN   4 Lower-MENU   5 ENTER

1. Return to the previous menu; 2. Up or +; 3. Down or -; 4. Enter the next menu; 5. Save and return to the previous menu



First level menu	Secondary menu	Third level menu	Remark
Menu	1.Pan Degree	1.540      2.360	Pan angle selection
	2.Mic Sense	001--100	Sound sensitivity selection
	3.Language	1.English 2.Chinese	Select language
	4.No Signal	1.Black Out    2.Hold	
	5.Fan Set	1.Auto    2.Low    3.High	
	6.ArtNet Set	1.ArtNet Enable: 1.ON 2.OFF	When Artnet function is available
		2.Universe:0---255	
		3.IP Mode: A.2.X.X.X Auto B.10.X.X.X Auto C.Custom	
		4.IP(Custom IP):192.168.000.001	
		5.Sub Net Mask: 255.000.000.000	
	7.Reset	1.Yes	Reset
		2.No	
	8.Default	1.Yes	Restore factory settings
		2.No	

	9.Adjust	Pass Word: ****		Changing the values of Pan/Tilt/Focus/Rota can correct the angle; changing the values of R/G/B/W can adjust the white balance
		1.Pan:0--255		
		2.Tilt:0--255		
		3.Focus:0--255		
		4.Red: 0--255		
		5.Greed: 0--255		
		6.Blue: 0--255		
		7.White: 0--255		
Address	001--512			Setting address 001--512
Reverse	1.Pan Invert	1.YES	2.NO	Pan forward and reverse settings
	2.Tilt Invert	1.YES	2.NO	Tilt forward and reverse settings
	3.Display Invert	1.YES	2.NO	Display reverse settings
Information	1.CH Value			Display all channel information
	2.Tem**°C			Display LED board temperature
	3.Version:**			Program version number
	4.IP:** ** ** *			When Artnet function is available
	5.mask.** ** ** *			When Artnet function is available
Mode	1.DMX512			Setting control mode
	2.Auto			
	3.Sound			

	4.Manual	Master/Alone	Manual control
		1.Pan:0--255	
		2.Tilt:0--255	
		3.Focus:0--255	
		4.Red 1: 0--255	
		5.Greed 1: 0--255	
		6.Blue 1: 0--255	
		7.White 1: 0--255	
		8.Strobe 1: 0-255	
		9.Red 2: 0--255	
		10.Green 2: 0--255	
		11.Blue 2: 0--255	
		12.White 2: 0--255	
		13.Strobe2: 0-255	
Channel	1.27Channels	1.27CH	Select Channel mode
	2.35Channels	2.35CH	
	3.45Channels	3.45CH	
	4.71Channels	4.71CH	
	5.80Channels	5.80CH	
	6.76Channels	6.76CH	

6. LUX Data

Beam Angle = 4.5°

WASH LED

R lux	146000	16222	5840	2979	1460
G lux	317500	35277	12700	6479	3175
B lux	61500	6833	2460	1255	615
W lux	457500	50833	18300	9336	4575
4in1 lux	857500	95277	34300	17500	8575

Ring LED

R lux	86	21.5	5.3	2.4	0.9
G lux	238	59.5	14.8	6.6	2.4
B lux	53.6	13.4	3.3	1.5	0.5
W lux	177	44.3	11	5	1.8
4in1 lux	488	122	30.5	13.5	5

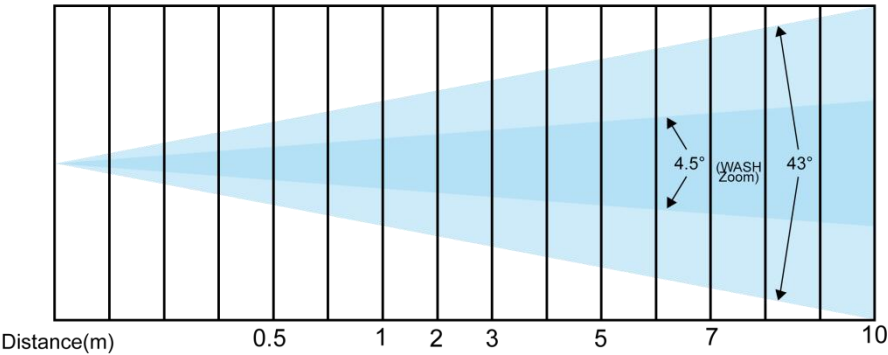

7. DMX Channel List

► 27CH Mode

CH	Function		DMX Value	Description
1	Middle	Red	0-255	Red dimming

CH	Function		DMX Value	Description
2	40W LED	Red adjustment	0-255	Red adjustment
3		Green	0-255	Green dimming
4		Green adjustment	0-255	Green adjustment
5		Blue	0-255	Blue dimming
6		Blue adjustment	0-255	Blue dimming
7		White	0-255	White dimming
8		White adjustment	0-255	White adjustment
9		Color temperature		0--15
			16--35	R100%,G UP,B0%
			36--55	R DOWN,G100%,B0%
			56--75	R0%,G100%,B UP
			76--95	R0%,G DOWN,B100%
			96--115	R UP,G0%,B100%
			116--135	R100%,G0%,B DOWN
			136--155	R100%,G UP,B UP
			156--175	R DOWN,G DOWN, B 100%
			176--195	R100%G100%B100%W100%
			196--200	2800K
			201--205	3200K
			206--210	3500K
			211--215	4000K

CH	Function		DMX Value	Description
			216--220	4500K
			221--225	5000K
			226--230	5500K
			231--235	6000K
			236--240	6500K
			241--245	7000K
			246--250	7500K
			251--255	8000K
10		Macro color	0--9	No function
			10--19	Macro color 1
			20--29	Macro color 2
			....	.... (10 numbers 1 macro color)
			240--249	Macro color 24
			250--255	Macro color 25
11		Dimming	0-255	From dark to bright
12		Dimmer adjust	0-255	Dimmer adjustment control
13		Strobe	0-3	Strobe dimming
			4--203	Synchronous strobe speed From slow to fast (1Hz-25Hz)
			204--255	Random strobe
14	Ring	R dimming	0-255	From dark to bright

CH	Function		DMX Value	Description
15		G dimming	0-255	From dark to bright
16		B dimming	0-255	From dark to bright
17		A dimming	0-255	From dark to bright
		Macro color	0-9	No function function
18			10-255	Macro color
19		Dimmer	0-255	From dark to bright
20		Strobe	0-3	Strobe dimming
			4--203	Synchronous strobe speed From slow to fast (1Hz-25Hz)
			204-255	Random strobe
21	Pan		0-255	Pan control
22	Tilt		0-255	Pan adjustment
23	Pan adjustment		0-255	Tilt control
24	Tilt adjustment		0-255	Tilt adjustment
25	Zoom		0-255	Zoom
26	Dimming mode		0-49	Model 1
			50--99	Model 2
			100-149	Model 3
			150-255	Model 4
27	Reset		0-250	No function function
			251-255	Reset within 5s

► 35CH Mode

CH	Function		DMX Value	Description
1	Pan		0--255	0--540°
2	Pan adjustment		0--255	16bit adjustable
3	Tilt		0--255	0--205°
4	Tilt adjustment		0--255	16bit adjustable
5	Pan/Tilt speed		0--255	From fast to slow
6	Zoom		0--255	From narrow to wide
7	Middle 40W LED	Dimmer	0--255	From dark to bright
8		Strobe	0--3	Strobe dimming
			4--203	Synchronous strobe speed From slow to fast (1Hz--25Hz)
			204--255	Random strobe
9		R dimming	0--255	From dark to bright
10		G dimming	0--255	From dark to bright
11		B dimming	0--255	From dark to bright
12		W dimming	0--255	From dark to bright
13		Color temperature	0 --15	No function
			16--35	R100%,G UP,B0%
			36--55	R DOWN,G100%,B0%
			56--75	R0%,G100%,B UP
			76--95	R0%,G DOWN,B100%
			96--115	R UP,G0%,B100%
			116--135	R100%,G0%,B DOWN
			136--155	R100%,G UP,B UP
			156--175	R DOWN,G DOWN, B 100%
			176--195	R100%,G100%,B100%,W100%
			196--200	2800K
			201--205	3200K
			206--210	3500K
			211--215	4000K
			216--220	4500K
			221--225	5000K
			226----230	5500K
			231----235	6000K
			236----240	6500K



CH	Function		DMX Value	Description
			241----245	7000K
			246----250	7500K
			251----255	8000K
14		Macro color	0----9	No function
			10----19	Macro color 1
			20----29	Macro color 2
			....	....(10 numbers 1 macro color)
			240----249	Macro color 24
			250----255	Macro color 25
15		Dynamic pattern	0----9	No function
			10----14	Monochrome dynamic pattern 1
			15----19	Monochrome dynamic pattern 2
			.....	.....(5 numbers 1 macro color)
			155----159	Monochrome dynamic pattern 30
			160----164	Mixed color dynamic pattern 1
			165----169	Mixed color dynamic pattern 2
			.....	.....(5 numbers 1 macro color)
			220----224	Mixed color dynamic pattern 13
			225----255	Mixed color dynamic pattern 14
16		Pattern speed (with 15CH)	0----127	Forward, from fast to slow
128----255			Reverse, from slow to fast	
17		Background R	0--255	From dark to bright
18		Background G	0--255	From dark to bright
19		Background B	0--255	From dark to bright
20		Background W	0--255	From dark to bright
21	Dimmer	0--255	From dark to bright	
22	Ring	Strobe	0--3	Strobe dimming
			4--203	Synchronous strobe speed From slow to fast (1Hz--25Hz)

CH	Function	DMX Value	Description
		204---255	Random strobe
23	R dimming	0--255	From dark to bright
24	G dimming	0--255	From dark to bright
25	B dimming	0--255	From dark to bright
26	A dimming	0--255	From dark to bright
27	Macro color	0--9	No function
		10--255	Macro color
28	Dynamic pattern	0---9	No function
		10---12	Dynamic Pattern 1
		13---15	Dynamic Pattern 2
		..... (3 numbers 1 pattern))	.....
		76---78	Dynamic Pattern 23
		79---255	Reserve
29	Pattern movement(with 29CH)	0--250	Select Pattern Scene
30	Pattern effect speed(with 29CH)	0---9	No function
		10---132	Clockwise, from fast to slow
		133---255	Counterclockwise, from slow to fast
31	Background R(with 29CH)	0--255	From dark to bright
32	Background G(with 29CH)	0--255	From dark to bright
33	Background B(with 29CH)	0--255	From dark to bright
34	Background W(with 29CH)	0--255	From dark to bright
35	Reset	0--250	No function
		251--255	Reset within 5s

## ► 45CH Mode

CH	Function	DMX Value	Description
1	Pan	0-255	0-540°
2	Pan adjustment	0-255	16bit adjustment

CH	Function		DMX Value	Description
3	Tilt		0-255	0-205°
4	Tilt adjustment		0-255	16bit adjustment
5	Pan/Tilt speed		0-255	From fast to slow
6	Zoom		0-255	From narrow to wide
7	Dimming Mode		0-49	Mode 1
			50-99	Mode 2
			100-149	Mode 3
			150-255	Mode 4
8	Middle 40W LED	Dimmer	0-255	From dark to bright
9		Dimmer adjust	0-255	Dimmer adjustment control
10		Strobe	0-3	Strobe dimming
			4-203	Synchronous strobe speed From slow to fast (1Hz--25Hz)
			204--255	Random strobe
11		Red	0-255	Red dimming
12		Red adjustment	0-255	Red adjustment
13		Green	0-255	Green dimming
14		Green adjustment	0-255	Green adjustment
15		Blue	0-255	Blue dimming
16		Blue adjustment	0-255	Blue adjustment
17		White	0-255	White dimming
18		White adjustment	0-255	White adjustment
19		Color temperature	0 -15	No function
			16-35	R100%,G UP,B0%
			36-55	R DOWN,G100%,B0%
	56-75		R0%,G100%,B UP	
	76-95		R0%,G DOWN,B100%	
	96-115		R UP,G0%,B100%	
	116-135		R100%,G0%,B DOWN	
	136-155		R100%,G UP,B UP	
	156-175		R DOWN,G DOWN, B 100%	
	176-195		R100%,G100%,B100%,W100%	
	196-200		2800K	

CH	Function		DMX Value	Description
			201-205	3200K
			206-210	3500K
			211-215	4000K
			216-220	4500K
			221-225	5000K
			226--230	5500K
			231--235	6000K
			236--240	6500K
			241--245	7000K
			246--250	7500K
			251--255	8000K
20		Macro color	0--9	No function
			10--19	Macro color 1
			20--29	Macro color 2
			....	....(10 numbers 1 macro color)
			240--249	Macro color 24
			250--255	Macro color 25
21		Dynamic pattern	0--9	No function
			10--14	Monochrome dynamic pattern 1
			15--19	Monochrome dynamic pattern 2
			.....	.....(5 numbers 1 pattern)
			155--159	Monochrome pattern 30
			160--164	Mixed color dynamic pattern 1
			165--169	Mixed color dynamic pattern 2
			.....	.....(5 numbers 1 pattern)
			220--224	Mixed color dynamic pattern 13
			225--255	Mixed color dynamic pattern 14
22		Dynamic pattern speed (with 21CH)	0--9	No function
			10--132	Clockwise, from fast to slow
			133--255	Counterclockwise, from slow to fast
23		Pattern effect	0-255	Pattern effect fade

CH		Function	DMX Value	Description
		fade		
24		Pattern dimming	0-255	Pattern 0-100% dimming
25		Pattern strobe	0-255	Pattern strobe
26		Back color R	0-255	From dark to bright
27		Back color G	0-255	From dark to bright
28		Back color B	0-255	From dark to bright
29		Back color W	0-255	From dark to bright
30		Dimmer	0-255	From dark to bright
31		Strobe	0--3	Strobe dimming
			4--203	Synchronous strobe speed From slow to fast (1Hz--25Hz)
			204--255	Random strobe
32		R dimming	0-255	From dark to bright
33		G dimming	0-255	From dark to bright
34		B dimming	0-255	From dark to bright
35		A dimming	0-255	From dark to bright
36		Macro color	0--9	No function
			10--255	Macro color
37	Ring	Dynamic pattern	0--9	No function
			10--12	Dynamic Pattern 1
			13--15	Dynamic Pattern 2
			.....（3 numbers 1 pattern）	.....
			76--78	Dynamic Pattern 23
			79--255	Reserve
38		Pattern movement(with 38CH)	0-250	Pattern move(with 38)
39		Pattern effect speed(with 38CH)	0----9	No function
			10----132	Clockwise, from fast to slow
			133----255	Counterclockwise, from slow to fast
40		Pattern fade	0-255	Pattern effect fade
41		Background R(with 38CH)	0--255	From dark to bright

CH	Function		DMX Value	Description
42		Background G(with 38CH)	0--255	From dark to bright
43		Background B(with 38CH)	0--255	From dark to bright
44		Background A(with 38CH)	0--255	From dark to bright
45	Reset		0-250	No function
			251-255	Reset within 5s

## ► 71CH Mode

CH	Function		DMX Value	Description
1	Pan		0-255	0-540°
2	Pan adjustment		0-255	16bit adjustment
3	Tilt		0-255	0-205°
4	Tilt adjustment		0-255	16bit adjustment
5	Pan/Tilt speed		0-255	From fast to slow
6	Zoom		0-255	From narrow to wide
7	Reset		0-250	No function
			251-255	Reset within 5s
8	Middle 40W LED	Dimmer	0-255	From dark to bright
9		Strobe	0--3	Strobe dimming
			4--203	Synchronous strobe speed From slow to fast (1Hz--25Hz)
			204--255	Random strobe
			10	R1 LED dimming
11		G1 LED dimming	0-255	G1 LED dimming
12		B1 LED dimming	0-255	B1 LED dimming
13		W1 LED dimming	0-255	W1 LED dimming
14		R2 LED dimming	0-255	R2 LED dimming
15		G2 LED dimming	0-255	G2 LED dimming
16		B2 LED dimming	0-255	B2 LED dimming
17		W2 LED dimming	0-255	W1 LED dimming
18		R3 LED dimming	0-255	R3 LED dimming
19		G3 LED dimming	0-255	G3 LED dimming
20		B3 LED dimming	0-255	B3 LED dimming

CH		Function	DMX Value	Description
21		W3 LED dimming	0-255	W3 LED dimming
22	Ring	Dimmer	0-250	From dark to bright
23		Strobe	0--3	Strobe dimming
			4--203	Synchronous strobe speed From slow to fast (1Hz--25Hz)
			204--255	Random strobe
24		R1 LED dimming	0-255	R1 LED dimming
25		G1 LED dimming	0-255	G1 LED dimming
26		B1 LED dimming	0-255	B1 LED dimming
27		A1 LED dimming	0-255	A1 LED dimming
.....		.....	.....	.....
68		R 12 LED dimming	0-255	R 12 LED dimming
69		G 12 LED dimming	0-255	G 12 LED dimming
70		B 12 LED dimming	0-255	B 12 LED dimming
71	A 12 LED dimming	0-255	A 12 LED dimming	

## ► 80CH Mode

CH	Function		DMX Value	Description
1		Pan	0-255	0-540°
2		Pan adjustment	0-255	16bit adjustment
3		Tilt	0-255	0-205°
4		Tilt adjustment	0-255	16bit adjustment
5		Pan/Tilt speed	0-255	From fast to slow
6		Zoom	0-255	From narrow to wide
7	Reset		0-250	No function
			251-255	Reset within 5s
8	Middle 40W LED	Dimmer	0-255	From dark to bright
9		Dimmer adjust	0-255	Dimmer adjustment control
10		Strobe	0--3	Strobe dimming

CH	Function		DMX Value	Description
			4--203	Synchro strobe speed From slow to fast (1Hz--25Hz)
			204--255	Random strobe
11		Red	0-255	Red dimming
12		Red adjustment	0-255	Red adjustment
13		Green	0-255	Green dimming
14		Green adjustment	0-255	Green adjustment
15		Blue	0-255	Blue dimming
16		Blue adjustment	0-255	Blue adjustment
17		White	0-255	White dimming
18		White adjustment	0-255	White adjustment
19		R1 LED dimming	0-255	R1 LED dimming
20		G1 LED dimming	0-255	G1 LED dimming
21		B1 LED dimming	0-255	B1 LED dimming
22		W1 LED dimming	0-255	W1 LED dimming
23		R2 LED dimming	0-255	R2 LED dimming
24		G2 LED dimming	0-255	G2 LED dimming
25		B2 LED dimming	0-255	B2 LED dimming
26		W2 LED dimming	0-255	W1 LED dimming
27		R3 LED dimming	0-255	R3 LED dimming
28		G3 LED dimming	0-255	G3 LED dimming
29		B3 LED dimming	0-255	B3 LED dimming
30		W3 LED dimming	0-255	W3 LED dimming
31	Ring	Dimmer	0-255	From dark to bright
32		Strobe	0--3	Strobe dimming
			4--203	Synchronous strobe speed From slow to fast (1Hz--25Hz)
				204--255
			33	R1 LED dimming
34		G1 LED dimming	0-255	G1 LED dimming
35		B1 LED dimming	0-255	B1 LED dimming
36		A1 LED dimming	0-255	A1 LED dimming
.....		.....	.....	.....
77		R12 LED dimming	0-255	R12 LED dimming
78	G12 LED dimming	0-255	G12 LED dimming	



CH	Function	DMX Value	Description
79	B12 LED dimming	0-255	B12 LED dimming
80	A12 LED dimming	0-255	A12 LED dimming

► **76CH Mode**(With ring control, 1CH to 7CH are controlled by DMX512, and 8CH to 76CH are controlled by ArtNet)

CH	Function	DMX Value	Description
1	Pan	0-255	0-540°
2	Pan adjustment	0-255	16bit adjustment
3	Tilt	0-255	0-205°
4	Tilt adjustment	0-255	16bit adjustment
5	Pan/Tilt speed	0-255	From fast to slow
6	Zoom	0-255	From narrow to wide
7	Reset	0-250	No function
		251-255	Reset within 5s
8	Dimmer	0-255	From dark to bright
9	Strobe	0--3	Strobe dimming
		4--203	Synchronous strobe speed From slow to fast (1Hz--25Hz)
		204--255	Random strobe
10	Dimming Mode	0-49	Mode 1
		50-99	Mode 2
		100-149	Mode 3
		150-255	Mode 4
11	R dimming	0-255	From dark to bright
12	G dimming	0-255	From dark to bright
13	B dimming	0-255	From dark to bright
14	W dimming	0-255	From dark to bright
15	R1 LED dimming	0-255	R1 LED dimming
16	G1 LED dimming	0-255	G1 LED dimming
17	B1 LED dimming	0-255	B1 LED dimming
18	W1 LED dimming	0-255	W1 LED dimming
19	R2 LED dimming	0-255	R2 LED dimming
20	G2 LED dimming	0-255	G2 LED dimming

CH		Function	DMX Value	Description
21		B2 LED dimming	0-255	B2 LED dimming
22		W2 LED dimming	0-255	W1 LED dimming
23		R3 LED dimming	0-255	R3 LED dimming
24		G3 LED dimming	0-255	G3 LED dimming
25		B3 LED dimming	0-255	B3 LED dimming
26		W3 LED dimming	0-255	W3 LED dimming
27		Dimmer	0-250	From dark to bright
28	Ring	Strobe	0--3	Strobe dimming
			4--203	Synchronous strobe speed From slow to fast (1Hz--25Hz)
			204--255	Random strobe
29		R1 LED dimming	0-255	R1 LED dimming
30		G1 LED dimming	0-255	G1 LED dimming
31		B1 LED dimming	0-255	B1 LED dimming
32		A1 LED dimming	0-255	A1 LED dimming
.....		.....	.....	.....
73		R12 LED dimming	0-255	R12 LED dimming
74		G12 LED dimming	0-255	G12 LED dimming
75		B12 LED dimming	0-255	B12 LED dimming
76		A12 LED dimming	0-255	A12 LED dimming

## 8. Mounting

When installing the unit, the trussing or area of installation must be able to hold 10 times the weight without any deformation. When installing the unit must be secured with a secondary safety attachment, e.g. an appropriate safety cable. Never stand directly under the facility while mounting, uninstalling or repairing facilities.

High-altitude mounting requires for extensive experience, including working load limits calculating , installation material, and periodic safety check of installation materials and facilities. If you're lack of mentioned qualifications, do

not attempt the installation yourself. These installation should be checked by a skilled person annually.

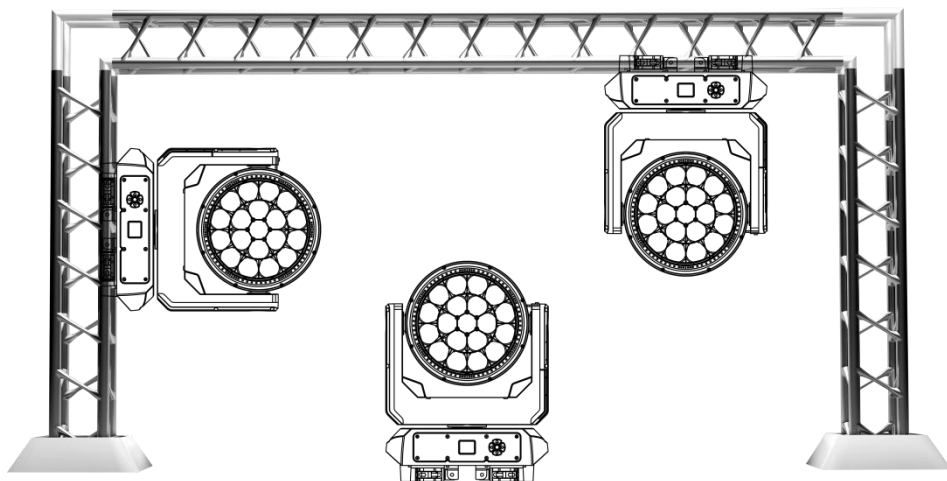

1940ZWR works properly in above different mounting, hanging upside-down from a ceiling, sideways on trussing, or set on smooth horizontal surface. Be sure this facility is at least 1m (3.5ft) away from flammable materials (decoration etc.). Always use and install the safety cable to prevent accidental damage or injury from the facility failure. Never use handles for secondary attachment.

**NOTICE:** The suitable environment temperature of the facility is from  $-10^{\circ}\text{C}$  to  $45^{\circ}\text{C}$ . Do not place this facility in an environment where the temperatures are under or above the temperatures stated. This will help the fixture run at its best and extend the lifetime.

## 9. Product Size

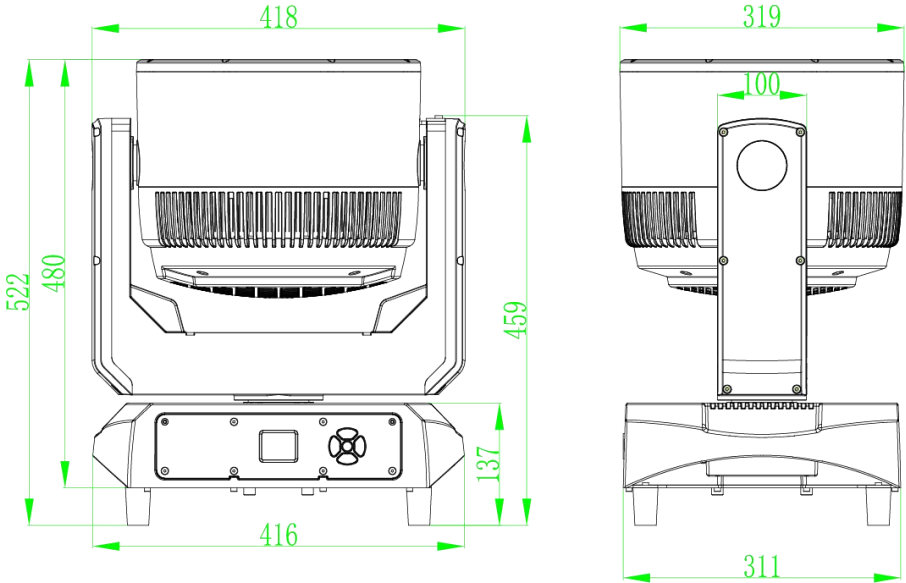

## 10. Attention

1. When the facility is powered on, please avoid looking directly at the facility.
2. When assembling/ replacing LEDs, be sure to cut off the main power of facilities before opening the cover upon the LED board.

## 11. Trouble Shooting

Following are a few common problems that may occur during operation. Here are some suggestions for easy troubleshooting:

### A. The unit does not work, no light and the fan does not work

1. Check the status of power connection and fuse.
2. Check the voltage.
3. Check the power indicator.

## **B. No response to DMX controller**

1. If the display screen flashes, check the DMX signal connector and signal line whether the connection is correct.
2. If the display screen does not flash, but no response to channel control, check whether the address code or channel setting is correct.
3. If the DMX signal transmission is intermittent, check if the XLR and DMX cables are in good condition.
4. Try using another controller.
5. Check if the DMX cables is too close to the high-voltage wire, which may damage or interfere with the signal circuit.
6. The facility has not completed the self-check.

## **C. One of the channels is not working well**

1. The stepper motor might be damaged or the cable connected to the PCB is broken.
2. The motor's drive IC on the PCB might be out of condition.

## **12. Fixture Cleaning**

The lens and diffuser should be clean frequently to get better light effect. Wipe frequency according to the environment. Humidity, excessive smoke, and dirty environment will make lens dusty.

- Use soft cloth and special glass cleaner.
- Wipe lens surface at least every 30 days.
- Use vacuum cleaners or air guns to clean the interior structure of the facility, at least twice a year.



### Warning:

To avoid the danger of lightning strikes and fire, please do not place the facility in a humid environment. Do not disassemble it without permission, otherwise, the manufacturer will not provide warranty. If the facility fails, please contact the manufacturer first.

## Product Warranty Card

Product: IP65 19\*40W Zoom Wash Moving Head With Ring

Model NO.: 1940ZWR

Manufacture Date:

User:

Purchase Date:

Manufacturer:

Sales Store:

Address:

ATTN.:

ATTN.:

Phone:

Phone:

Note: The above blank must be filled in and sealed by the end user or sales point, otherwise no warranty will be provided. (Below please check the warranty period and terms)

Warranty Period: This facility is warranted for 2 years from the date of purchase.

Warranty Terms:

1. Except for man-made damage and natural disasters
2. If the facility fails to function properly during the warranty period, please contact our after service department or our local distributor directly.
  - 1) Fail to present a valid warranty card.
  - 2) Omissions, alterations, and trade sales names on the warranty card.
  - 3) Failures and damage caused by force majeure.
  - 4) Failures and damage caused during transportation and handling.
  - 5) Failures and damage caused by failure to follow the instructions for use.
  - 6) Failures and damage caused by disassembly, repair, and modification of the product without the manufacturer's authorization or by non-professionals.
  - 7) Failures caused by the use of accessories not approved by the factory or not matched by the factory.

▲ Thank you for reading this manual. Please keep it for future reference.