

1920Z

19x20W Zoom WASH

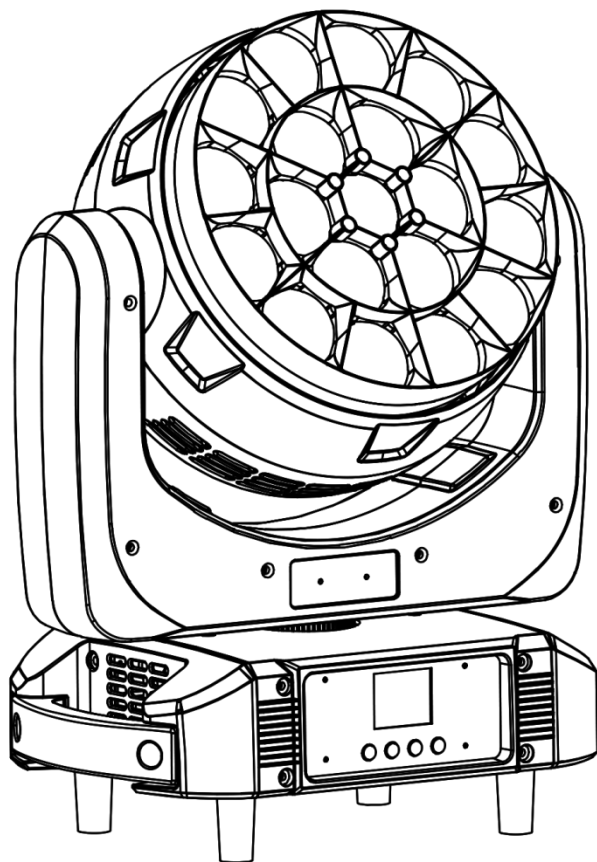

User Manual

Please read carefully before use

CONTENTS

1. Safety Instructions	4
2. Technical Specification	6
3. DMX Set Up	7
4. Display	8
5. Menu	9
6. LUX Data	11
7. DMX Channel List	11
8. Mounting	17
9. Product Size	18
10. Attention	19
11. Trouble Shooting	19
A. The unit does not work, no light and the fan does not work	19
B. Not responding to DMX controller	19
C. One of the channels is not working well	20
12. Fixture Cleaning	20

Thank you for choosing our LED lights. Each facility has been rigorously tested. Please check whether the facility has been damaged during transportation. If you find any parts are missing or broken, please contact the manufacturer immediately. Please do not return the product without any notice!

1.Safety Instructions



Please read this manual carefully, which includes important information on installation, use and maintenance.

Attention

- Please keep this USER MANUAL for future consultation. If you sell the facility to another user, be sure that they also receive this USER MANUAL.
- Please open and check in details and make sure there is no transportation damage.
- Before operating, ensure that the voltage and frequency of power supply match the power requirements of the facility.
- It's important to ground the yellow/green conductor to earth in order to avoid electric shock.
- The facility must be installed in a location with adequate ventilation, at least 50 cm from adjacent surfaces. Be sure that no ventilation slots are blocked.
- Make sure the power is disconnected before removing the facility.
- Make sure there are no flammable materials close to the unit while operating as it is fire hazard.
- Use safety cable when fixes this facility. Do not handle the facility by taking its head only, but always by taking its base.
- Maximum ambient temperature is 40 °C . Do not operate it where the temperature is higher than this.
- Please stop using the facility for serious operating problems. Stop using the facility immediately. Never try to repair the facility by yourself, but be a professional technician. Please contact the supplier's service department

for technical support.

- Do not touch any wire during operation as high voltage might be causing electric shock.
- When the housing or lens is damaged, it must be replaced.
- Direct sunlight or any other strong light source penetrating the lens of the light will cause serious internal damage to the facility. During unpacking, installation, use and long-term outdoor idleness, it is forbidden to expose the lens of the facility to direct sunlight or any other strong light source at any angle. It is forbidden to aim the beam of one light directly at another light.

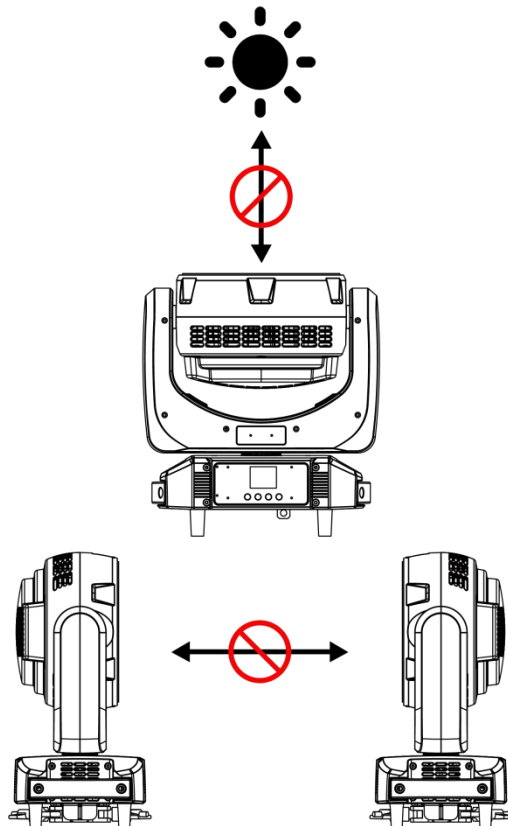

Caution

There are no accessories available, do not open the housing and try to repair the facilities yourself. Please contact our company for after service.

Installation

The unit should be mounted via its screw holes on the bracket. Always ensure that the unit is firmly fixed to avoid vibration and slipping while operating. And make sure that the structure to which you are attaching the unit is secure and is able to support a weight of 10 times of the unit's weight. Also always use a safety cable that can hold 12 times of the weight of the unit when installing the fixture.

The facility must be installed by professionals, and keep it far away from fire, walking road, and easy touched place.

2. Technical Specification

Light Source	19*20W 4 in 1 RGBW LED
LED Lifetime	≥ 50000H
Power Voltage	AC100-240V , 50-60Hz
Power Consumption	350W
Beam Angle	5.8°-55°
Control Modes	DMX512/ Auto/ Sound/ Master-Slave/ Manual/ RDM
DMX Channel	19/ 27 Channel
Protection Rating	IP20
Display	TFT 1.8' colorful reversible display, CN/ EN language
Data In/Out Socket	3-pin& 5-pin XLR sockets
Power Socket	Power-Con in/ out
Housing Material	ABS High temperature resistant plastics

Working Temperature	-10℃ - 45℃		
Pan	540° accuracy	2.11°/step,	fine-tuning accuracy: 0.008°
Tilt	270° accuracy	0.86°/step,	fine-tuning accuracy: 0.0034°
Pan/Tilt Resolution	Automatically correct pan/tilt position		
MAX. Connection	4 units (220V, 50Hz)	1.5mm ²	power cable
	2 units (120V, 60Hz)	1.5mm ²	power cable
Dimension	338*254*375mm		
Net Weight	8.5kg		
Carton Package	420*335*460mm	1in1	G.W.: 12kg
	690*440*485mm	4in1	G.W.: 23kg
Flight Case	875*608*575mm	4in1	G.W.: 70kg
Features	Full light range dimming, 65536-level dimming accuracy. Single control of LED. Double effects of WASH and beam. Preset multiple macro-color and macro-effect functions		
Configuration	Signal cable	1pc	
	Power cable	1pc	
	Manual	1pc	

3. DMX Set Up

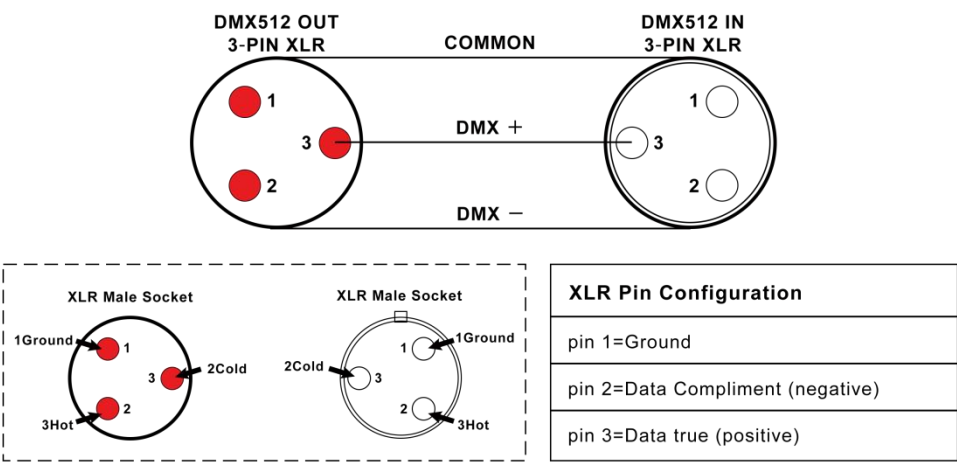

Pin1: Ground

pin2: Negative

pin3: Positive

DMX Connection

To ensure optimal transmission of DMX data, please connect facilities in the shortest way. The connection order won't affect the DMX address code. For example, if the address code is set to 1, no matter where the facility is connected, its address code will not change. This is determined by the principle of the DMX controller.

Operation method

You can operate in the following three modes:

- Auto mode - the light can automatically complete all color changes
- DMX control mode - each light can be individually controlled by a standard DMX512 console
- Master mode - any light can work as a host in any of the above modes, and the other lights will work synchronously as slaves

4. Display

There are four buttons on the LED panel: MENU, UP, DOWN, and ENTER.



MENU



UP



DOWN



ENTER

"MENU" to exit or return to the previous menu, "UP" or "DOWN" to select the upper and lower menus or adjust the values, and "ENTER" to confirm.

FRONT VIEW

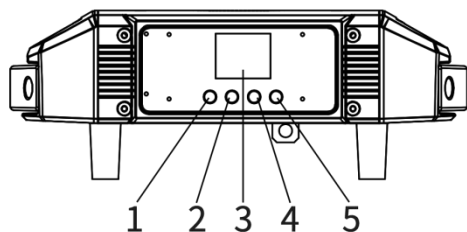

REAR VIEW

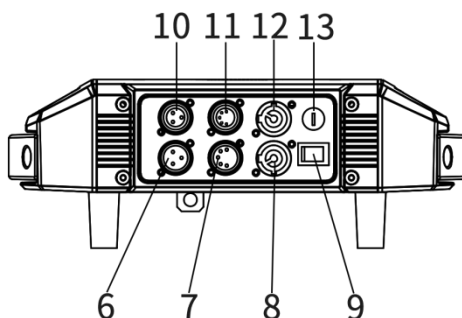

After powering on, the facility will automatically return to the last operation when it was powered off, then get into standby status. For more details, please refer to the information below↓

5. Menu

Menu	1. Pan Degree	1. 540 2. 360	Pan setting
	2. Mic Sense	001--100	Sound sensitivity setting
	3. Language	1. English	Language setting
		2. Chinese	
	4. No Signal	1. Block Out 2. Hold	Status setting(no signal)
	5. Fan Set	1. Auto 2. Low 3. High	Fan speed setting
	6. Reset	1. Yes	Reset
		2. No	
	7. Default	1. Yes	Reset to default
		2. No	
	8. Adjust	Pass Word: ****	Change the value of Pan/ Tilt/ Focus to adjust angle
		1. Pan: 0--255	
		2. Tilt: 0--255	
		3. Focus: 0--255	change the value of

			4. Rota: 0--255	R/G/B/W to adjute White Balance
			5. Red: 0--255	
			6. Green: 0--255	
			7. Blue: 0--255	
			8. White: 0--255	
Addr			001--512	Address setting: 001--512
Rever	1. Pan		1. YES 2. NO	Pan/ Tilt/ Display rever setting
	2. Tilt		1. YES 2. NO	
	3. Display		1. YES 2. NO	
Info			1. CH Value	Channels information
			2. Tem**°C	LED temperature
			3. Soft V1.1	Program version
Mode	1. DMX512			Control mode
	2. Auto		1. Master	
			2. Alone	
	3. Sound		1. Master	
			2. Alone	
	4. Manual	1. Master	1. Pan: 0--255	Manual control
			2. Tilt: 0--255	
			3. Focus: 0--255	
			4. Red: 0--255	
		2. Alone	5. Green: 0--255	
			6. Blue: 0--255	
			7. White: 0--255	
			8. Strobe: 0--255	
Channel	1. 19 Channels			Channels setting
	2. 27 Channels			

6. LUX Data

Beam Angle = 5.8°

R lux	11200	4410	1930	786
G lux	29500	12500	4700	1840
B lux	6850	2640	958	382
W lux	46300	18700	6900	2780
4in1 lux	85200	33600	12800	5030

Beam Angle = 55°

R lux	1320	163	53	25.1
G lux	3680	450	154	63.1
B lux	800	97.8	33.6	13.3
W lux	5520	687	236	95.4
4in1 lux	10200	1230	414	167

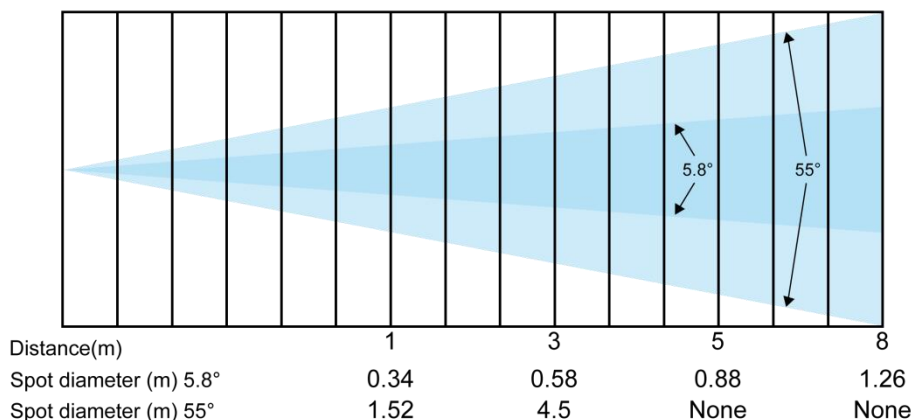

7. DMX Channel List

► 19CH Mode

Channel	Function	DMX Value	Description
1	Pan	0--255	Pan adjustment
2	Pan adjustment	0--255	Pan fine adjustment
3	Tilt	0--255	Tilt adjustment
4	Tilt adjustment	0--255	Tilt fine adjustment
5	Pan/Tilt speed	0--255	From fast to slow

Channel	Function	DMX Value	Description
6	Strobe	0--15	No function
		16--214	From slow to fast
		215--255	Random strobe
7	Dimmer	0--255	From dark to bright
8	Dimmer Mode	0--49	Mode 1
		50--99	Mode 2
		100--149	Mode 3
		150--255	Mode 4
9	Zoom	0--255	From narrow to wide
10	Red	0--255	From dark to bright
11	Green	0--255	From dark to bright
12	Blue	0--255	From dark to bright
13	White	0--255	From dark to bright
14	Static color	0--15	No function
		16--35	R 100%, G up, B 0%
		36--55	R down, G 100%, B 0%
		56--75	R 0%, G 100%, B up
		76--95	R 0%, G 100%, B up
		96--115	R up, G 0%, B 100%
		116--135	R 100%, G 0%, B down
		136--155	R 100%, G up, B up
		156--175	R down G down, B 100%
		176--195	R 100%, G 100%, B 100%, W 100%
		196--200	2800K
		201--205	3200K
		206--210	3500K
		211--215	4000K
		216--220	4500K

Channel	Function		DMX Value	Description
			221--225	5000K
			226--230	5500K
			231--235	6000K
			236--240	6500K
			241--245	7000K
			246--250	7500K
			251--255	8000K
15	Effects		0--9	No effect
			10--99	3 numbers 1 effect
			100--149	Jump
			150--255	gradual change
16	Zone		0--19	No function
			20--39	Zone --1
			40--59	Zone --2
			60--79	Zone --3
			80--99	Zone --4
			100--119	Zone --5
		Automatic ally transform zone	120--139	Zone --6
			140--159	Zone --7
			160--179	Zone--8
			180--199	Zone --9
			200--219	Zone --10
			220--255	Zone --11
17	Zone change speed		0--255	Zone 7--Zone 11
18	Zone change fade		0--255	Zone 7--Zone 11
19	Reset		0--79	No function
			80--99	Reset
			100--255	No function

► 27CH Mode

Channel	Function	DMX Value	Description
1	Pan	0--255	Pan adjustment
2	Pan adjustment	0--255	Pan fine adjustment
3	Tilt	0--255	Tilt adjustment
4	Tilt adjustment	0--255	Tilt fine adjustment
5	Pan/Tilt speed	0--255	From fast to slow
6	Strobe	0--15	No function
		16--214	From slow to fast
		215--255	Random strobe
7	Dimming	0--255	From dark to bright
8	Dimming Mode	0--49	Mode 1
		50--99	Mode 2
		100--149	Mode 3
		150--255	Mode 4
9	Zoom	0--255	From narrow to wide
10	Red 1	0--255	From dark to bright
11	Green 1	0--255	From dark to bright
12	Blue 1	0--255	From dark to bright
13	White 1	0--255	From dark to bright
14	Red 2	0--255	From dark to bright
15	Green 2	0--255	From dark to bright
16	Blue 2	0--255	From dark to bright
17	White 2	0--255	From dark to bright
18	Red 3	0--255	From dark to bright

Channel	Function	DMX Value	Description
19	Green 3	0--255	From dark to bright
20	Blue 3	0--255	From dark to bright
21	White 3	0--255	From dark to bright
22	Static color	0--15	No function
		16--35	R 100%, G up, B 0%
		36--55	R down, G 100%, B 0%
		56--75	R 0%, G 100%, B up
		76--95	R 0%, G down, B 100%
		96--115	R up, G 0%, B 100%
		116--135	R 100%, G 0%, B down
		136--155	R 100%, G up, B up
		156--175	R down, G down, B 100%
		176--195	R 100%, G 100%, B 100%, W 100%
		196--200	2800K
		201--205	3200K
		206--210	3500K
		211--215	4000K
		216--220	4500K
		221--225	5000K
		226--230	5500K
		231--235	6000K
		236--240	6500K
		241--245	7000K
		246--250	7500K

Channel	Function		DMX Value	Description
			251--255	8000K
23	Effects		0--9	No function
			10--99	3 numbers 1 effect
			100--149	Jump
			150--255	Gradual change
24	Zone		0--19	No function
			20--39	Zone 1
			40--59	Zone 2
			60--79	Zone 3
			80--99	Zone 4
			100--119	Zone 5
			120--139	Zone 6
	Automatically transform zone	140--159	Zone 7	
		160--179	Zone 8	
		180--199	Zone 9	
		200--219	Zone 10	
		220--255	Zone 11	
25	Zone change speed		0--255	Zone 7--Zone 11
26	Zone change fade		0--255	Zone 7--Zone 11
27	Reset		0--79	No function
			80--99	Reset
			100--255	No function

8. Mounting

When installing the unit, the trussing or area of installation must be able to hold 10 times the weight without any deformation. When installing the unit must be secured with a secondary safety attachment, e.g. an appropriate safety cable. Never stand directly under the facility while mounting, uninstalling or repairing facilities.

High-altitude mounting requires for extensive experience, including working load limits calculating , installation material, and periodic safety check of installation materials and facilities. If you're lack of mentioned qualifications, do not attempt the installation yourself. These installation should be checked by a skilled person annually.

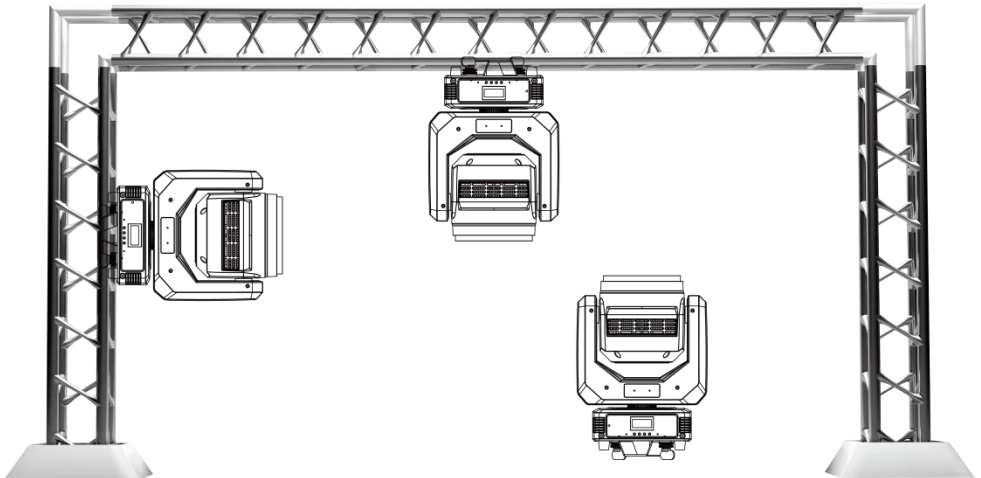

1920Z works properly in above different mounting, hanging upside-down from a ceiling, sideways on trussing, or set on smooth horizontal surface. Be sure this facility is at least 12m (40ft) away from flammable materials (decoration

etc.). Always use and install the safety cable to prevent accidental damage or injury from the facility failure. Never use handles for secondary attachment.

NOTICE: The suitable environment temperature of the facility is from -25° C to 45° C. Do not place this facility in an environment where the temperatures are under or above the temperatures stated. This will help the fixture run at its best and extend the lifetime.

9. Product Size

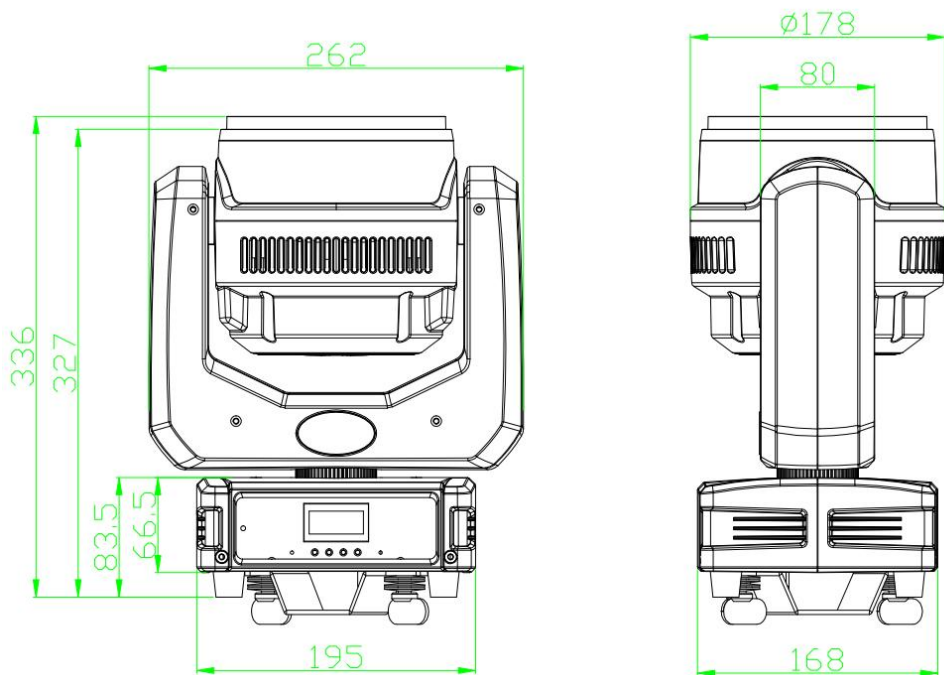

10. Attention

1. When the facility is powered on, please avoid looking directly at the facility.
2. When assembling/ replacing LED, be sure to cut off the main power of facilities before opening the cover upon the LED board.

11. Trouble Shooting

Following are a few common problems that may occur during operation. Here are some suggestions for easy troubleshooting:

A. The unit does not work, no light and the fan does not work

1. Check the status of power connection and fuse.
2. Check the voltage.
3. Check the power indicator.

B. No response to DMX controller

1. If the display screen flashes, check the DMX signal connector and signal line whether the connection is correct.
1. If the display screen does not flash, but no response to channel control, check whether the address code or channel setting is correct.
1. If the DMX signal transmission is intermittent, check if the XLR and DMX cables are in good condition.
2. Try using another controller.
3. Check if the DMX cables is too close to the high-voltage wire, which may damage or interfere with the signal circuit.
6. The facility has not completed the self-check.

C. One of the channels is not working well

1. The stepper motor might be damaged or the cable connected to the PCB is broken.
2. The motor's drive IC on the PCB might be out of condition.

12. Fixture Cleaning

The lens and diffuser should be clean frequently to get better light effect. Wipe frequency according to the environment. Humidity, excessive smoke, and dirty environment will make lens dusty.

- Use soft cloth and special glass cleaner.
- Wipe lens surface at least every 30 days.
- Use vacuum cleaners or air guns to clean the interior structure of the facility, at least twice a year.



Warning:

To avoid the danger of lighting strikes and fire, please do not place the facility in a humid environment. Do not disassemble it without permission, otherwise, the manufacturer will not provide warranty. If the facility fails, please contact the manufacturer first.

Product Warranty Card

Product: 19x20W Zoom WASH

Model NO.: 1920Z

Manufacture Date:

User:

Purchase Date:

Manufacturer:

Sales Store:

Address:

ATTN.:

ATTN.:

Phone:

Phone:

Note: The above blank must be filled in and sealed by the end user or sales point, otherwise no warranty will be provided. (Below please check the warranty period and terms)

Warranty Period: This facility is warranted for 2 years from the date of purchase.

Warranty Terms:

1. Except for man-made damage and natural disasters
2. If the facility fails to function properly during the warranty period, please contact our after service department or our local distributor directly.
 - 1) Fail to present a valid warranty card.
 - 2) Omissions, alterations, and trade sales names on the warranty card.
 - 3) Failures and damage caused by force majeure.
 - 4) Failures and damage caused during transportation and handling.
 - 5) Failures and damage caused by failure to follow the instructions for use.
 - 6) Failures and damage caused by disassembly, repair, and modification of the product without the manufacturer's authorization or by non-professionals.
 - 7) Failures caused by the use of accessories not approved by the factory or not matched by the factory.

▲ Thank you for reading this manual. Please keep it for future reference.