

1920B

19x20W Bee Eye Zoom

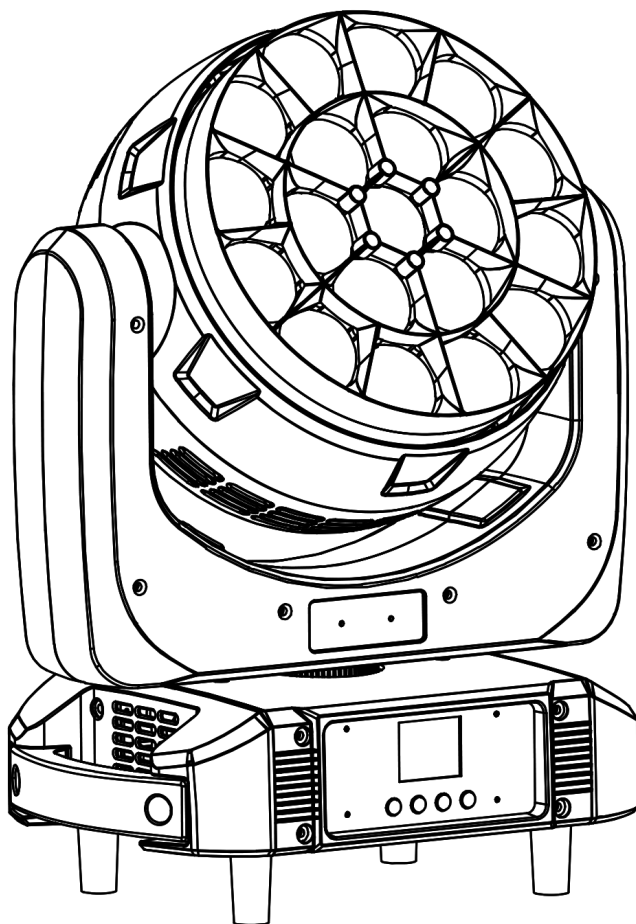

User Manual

Please read carefully before use

CONTENTS

1. Safety Instructions	4
2. Technical Specification	6
3. DMX Set Up	7
4. Display	8
5. Menu	9
6. LUX Data	11
7. DMX Channel List	12
8. Mounting	28
9. Product Size	29
10. Attention	30
11. Trouble Shooting	30
A. The unit does not work, no light and the fan does not work	30
B. Not responding to DMX controller	30
C. One of the channels is not working well	31
12. Fixture Cleaning	31

Thank you for choosing our LED lights. Each facility has been rigorously tested. Please check whether the facility has been damaged during transportation. If you find any parts are missing or broken, please contact the manufacturer immediately. Please do not return the product without any notice!

1.Safety Instructions



Please read this manual carefully, which includes important information on installation, use and maintenance.

Attention

- Please keep this USER MANUAL for future consultation. If you sell the facility to another user, be sure that they also receive this USER MANUAL.
- Please open and check in details and make sure there is no transportation damage.
- Before operating, ensure that the voltage and frequency of power supply match the power requirements of the facility.
- It's important to ground the yellow/green conductor to earth in order to avoid electric shock.
- The facility must be installed in a location with adequate ventilation, at least 50 cm from adjacent surfaces. Be sure that no ventilation slots are blocked.
- Make sure the power is disconnected before removing the facility.
- Make sure there are no flammable materials close to the unit while operating as it is fire hazard.
- Use safety cable when fixes this facility. Do not handle the facility by taking its head only, but always by taking its base.
- Maximum ambient temperature is 40 °C . Do not operate it where the temperature is higher than this.
- Please stop using the facility for serious operating problems. Stop using the facility immediately. Never try to repair the facility by yourself, but be a professional technician. Please contact the supplier's service department

for technical support.

- Do not touch any wire during operation as high voltage might be causing electric shock.
- When the housing or lens is damaged, it must be replaced.
- Direct sunlight or any other strong light source penetrating the lens of the light will cause serious internal damage to the facility. During unpacking, installation, use and long-term outdoor idleness, it is forbidden to expose the lens of the facility to direct sunlight or any other strong light source at any angle. It is forbidden to aim the beam of one light directly at another light.

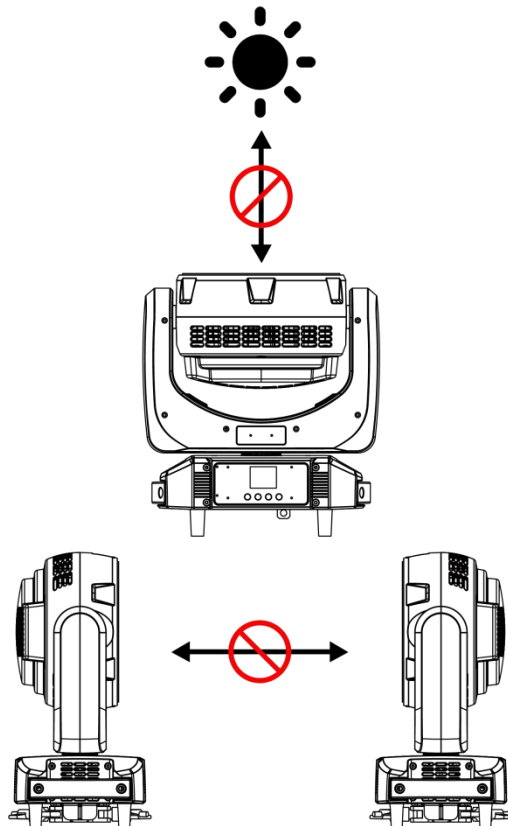

Caution

There are no accessories available, do not open the housing and try to repair the facilities yourself. Please contact our company for after service.

Installation

The unit should be mounted via its screw holes on the bracket. Always ensure that the unit is firmly fixed to avoid vibration and slipping while operating. And make sure that the structure to which you are attaching the unit is secure and is able to support a weight of 10 times of the unit's weight. Also always use a safety cable that can hold 12 times of the weight of the unit when installing the fixture.

The facility must be installed by professionals, and keep it far away from fire, walking road, and easy touched place.

2. Technical Specification

Light Source	19*20W 4 in 1 RGBW LED
LED Lifetime	≥ 50000H
Power Voltage	AC100-240V , 50-60Hz
Power Consumption	350W
Beam Angle	5.8°-55°
Control Modes	DMX512/ Auto/ Sound/ Master-Slave/ Manual/ RDM
DMX Channel	21/ 23/ 35/ 78/ 92/ 97/ 99 Channel
Protection Rating	IP20
Display	TFT 1.8' colorful reversible display, CN/ EN language
Data In/Out Socket	3-pin& 5-pin XLR sockets
Power Socket	Power-Con in/ out
Housing Material	ABS High temperature resistant plastics
Working Temperature	-10℃ - 45℃

Pan	540° accuracy 2.11°/step, fine-tuning accuracy: 0.008°		
Tilt	270° accuracy 0.86°/step, fine-tuning accuracy: 0.0034°		
Pan/Tilt Resolution	Automatically correct pan/tilt position		
MAX. Connection	4 units (220V, 50Hz)	1.5mm ²	power cable
	2 units (120V, 60Hz)	1.5mm ²	power cable
Dimension	338*254*375mm		
Net Weight	8.5kg		
Carton Package	420*335*460mm	1in1	G.W.: 12kg
	690*440*485mm	2in1	G.W.: 23kg
Flight Case	875*608*575mm	4in1	G.W.: 71.84kg
Features	Full light range dimming, 65536-level dimming accuracy. Single control of LED. Triple effects of WASH, beam, and bee eye. Preset multiple macro-color and macro-effect functions		
Configuration	Signal cable	1pc	
	Power cable	1pc	
	Manual	1pc	

3. DMX Set Up

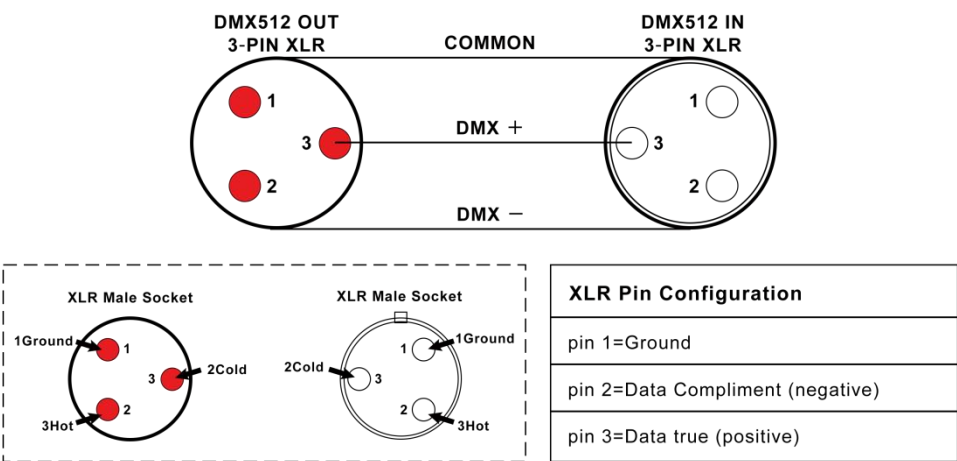

DMX Connection

To ensure optimal transmission of DMX data, please connect facilities in the shortest way. The connection order won't affect the DMX address code. For example, if the address code is set to 1, no matter where the facility is connected, its address code will not change. This is determined by the principle of the DMX controller.

Operation method

You can operate in the following three modes:

- Auto mode - the light can automatically complete all color changes
- DMX control mode - each light can be individually controlled by a standard DMX512 console
- Master mode - any light can work as a host in any of the above modes, and the other lights will work synchronously as slaves

4. Display

There are four buttons on the LED panel: MENU, UP, DOWN, and ENTER.



MENU



UP



DOWN



ENTER

"MENU" to exit or return to the previous menu, "UP" or "DOWN" to select the upper and lower menus or adjust the values, and "ENTER" to confirm.

FRONT VIEW

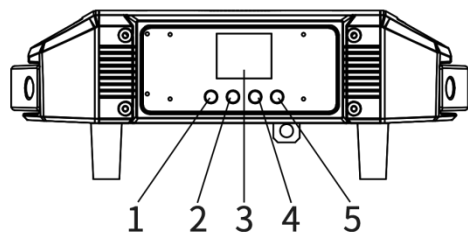

REAR VIEW

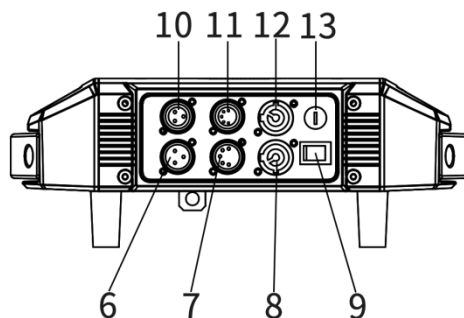

After powering on, the facility will automatically return to the last operation when it was powered off, then get into standby status. For more details, please refer to the information below↓

5. Menu

1-MENU 2-UP 3-DOWN 4-ENTER			
Menu	1. Pan Degree	1.540 2.360	Pan degree options
	2. Mic Sense	001--100	Sound sensitivity setting
	3. Language	1. English	Language
		2. Chinese	
	4. No Signal	1. BlackOut 2. Hold	No signal status setting
	5. Fan Set	1. Auto 2. Low 3. High	Fan running speed
	6. Reset)	1. Yes	Reset
		2. No	
	7. Default	1. Yes	Default
		2. No	
	8. Adjust	Pass Word: ****	Adjust Pan/ Tilt/ Focus/ Rota value to correct angle
		1. Pan: 0--255	
		2. Tilt: 0--255	

	8. Adjust	3. Focus: 0--255	Adjust R/ G/ B/ W value to correct White Balance
		4. Rota: 0-255	
		5. Red: 0--255	
		6. Green: 0--255	
		7. Blue: 0--255	
		8. White: 0--255	
Addr		001--512	Address 001--512
Rever	1. Pan	1. YES 2. NO	Pan/ Tilt/ Display rever
	2. Tilt	1. YES 2. NO	
	3. Display	1. YES 2. NO	
Inform		1. CH Value	All Channels info
		2. Tem**°C	LED board temperature
		3. Soft V***	Program version
Mode	1. DMX512		Control mode setting
	2. Auto	1. Master	
		2. Alone	
	3. Sound	1. Master	
		2. Alone	
	4. Manual	1. Pan 0--255	Manual control
		2. Tilt 0--255	
		3. Focus 0--255	
		4. Rota 0-255	
		5. Red 0--255	
		6. Green 0--255	
		7. Blue 0--255	
		8. White 0--255	
		9. Strobe 0-255	
Channel	1. 21 Channels	21 Channels	Channels Mode
	2. 23	23 Channels	

Channel	Channels		
	3. 35 Channels	35 Channels	
	4. 78 Channels	78 Channels	
	5. 92 Channels	92 Channels	
	6. 97 Channels	97 Channels	
	7. 99 Channels	99 Channels	

6. LUX Data

Beam Angle = 5.8°

R lux	12100	5380	2060	853
G lux	23000	11400	4150	1720
B lux	5030	2420	900	368
W lux	45600	16900	6750	2710
4in1 lux	69200	32900	12000	4930

Beam Angle = 55°

R lux	3410	483	155	66
G lux	6950	967	314	142
B lux	1590	219	70.7	32.1
W lux	11400	1550	508	228
4in1 lux	20300	2830	919	409

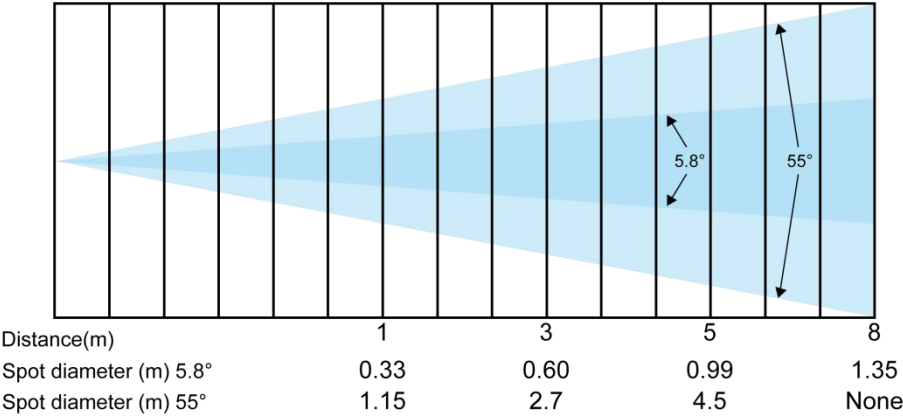

7. DMX Channel List

► 21CH Mode

Channel	Function	DMX Value	Description
1	Red	0--255	Red dimming
2	Red adjustment	0--255	Red fine adjustment
3	Green	0--255	Green dimming
4	Green adjustment	0--255	Green fine adjustment
5	Blue	0--255	Blue dimming
6	Blue adjustment	0--255	Blue fine adjustment
7	White	0--255	White dimming
8	White adjustment	0--255	White fine adjustment
9	Color temperature	0--4	No function
		5--255	From warm to cold
10	Macro color	0--9	No function
		10--19	Macro color 1
		20--29	Macro color 2
	 (10 numbers 1 macro color)
		240--249	Macro color 24
		250--255	Macro color 25
11	Strobe	0--3	Off
		4--103	Synchro strobe speed slow to fast (1Hz--25Hz)
		104--107	Open
		108--207	Fast to slow
		208--212	Open
		213--251	Random strobe
		252--255	Open

Channel	Function	DMX Value	Description
12	Dimmer	0--255	dark to bright linear dimming
13	Dimmer adjust	0--255	Dimmer adjustment control
14	Pan	0--255	Pan adjustment
15	Pan adjustment	0--255	Pan fine adjustment
16	Tilt	0--255	Tilt adjustment
17	Tilt adjustment	0--255	Tilt fine adjustment
18	Dimming Mode	0--42	Mode 1
		43--47	Mode 2
		48--52	Mode 3
		53--57	Mode 4
19	Reset	0--250	No function
		251--255	Reset within 5s
20	Zoom	0--255	From narrow to wide
21	Lens rotation	0--155	0~60°
		156--205	Clockwise infinite rotation
		206--255	Counterclockwise rotation

► 23CH Mode

Channel	Function	DMX Value	Description
1	Pan	0--255	0--540°
2	Pan adjustment	0--255	16bit adjustment
3	Tilt	0--255	0--205°
4	Tilt adjustment	0--255	16bit adjustment
5	Pan/Tilt speed	0--255	From fast to slow
6	Zoom	0--255	From narrow to wide
7	Lens rotation	0--155	0~60°

Channel	Function	DMX Value	Description
		156--205	Clockwise infinite rotation from fast to slow
		206--255	Counterclockwise rotation from slow to fast
8	Dimmer	0--255	dark to bright linear dimming
9	Strobe	0--3	Off
		4--103	Synchro strobe speed
			From slow to fast (1Hz--25Hz)
		104--107	On
		108--207	From fast to slow
		208--212	On
		213--251	Random strobe
		251--255	On
10	R dimming	0--255	From dark to bright
11	G dimming	0--255	From dark to bright
12	B dimming	0--255	From dark to bright
13	W dimming	0--255	From dark to bright
14	Color temperature	0--4	No function
		5--255	From warm to cold
15	Macro color	0--9	No function
		10--19	Macro color 1
		20--29	Macro color 2
	 (10 numbers 1 macro color)
		240--249	Macro color 24
			Macro color 25
16	Static pattern	0--9	No function
		10--12	Monochrome pattern 1

Channel	Function	DMX Value	Description
		13--15	Monochrome pattern 2
	(3 numbers 1 pattern)
		208--210	Monochrome pattern 67
		211--213	Mixed color pattern 1
		214--216	Mixed color pattern 2
	 (3 numbers 1 pattern)
		250--252	Mixed color pattern 14
		253--255	Mixed color pattern 15
17	Dynamic pattern	0--9	No function
		10--14	Monochrome dynamic pattern 1
		15--19	Monochrome dynamic pattern 2
	(5 numbers 1 pattern)
		155--159	Monochrome pattern 30
		160--164	Mixed color dynamic pattern 1
		165--169	Mixed color dynamic pattern 2
	(5 numbers 1 pattern)
		220--224	Mixed color dynamic pattern 13
		225--255	Mixed color dynamic pattern 14
18	Pattern speed	0--127	Forward, from fast to slow (with 17CH)
		128--255	Reverse, from slow to fast (with 17CH)
19	Background R	0--255	From dark to bright

Channel	Function	DMX Value	Description
20	Background G	0--255	From dark to bright
21	Background B	0--255	From dark to bright
22	Background W	0--255	From dark to bright
23	Reset	0--250	No function
		251--255	Reset within 5s

► 35CH Mode

Channel	Function	Value	Description
1	Red	0--255	Red dimming
2	Red adjustment	0--255	Red fine adjustment
3	Green	0--255	Green dimming
4	Green adjustment	0--255	Green fine adjustment
5	Blue	0--255	Blue dimming
6	Blue adjustment	0--255	Blue fine adjustment
7	White	0--255	White dimming
8	White adjustment	0--255	White fine adjustment
		0--4	No function
9	Color temperature	5--255	From warm to cold
10	Macro color	0--9	No function
		10--19	Macro color 1
		20--29	Macro color 2
	 (10 numbers 1 macro color)
		240--249	Macro color 24
		250--255	Macro color 25
11	Strobe	0--3	Off
		4--103	Synchro strobe speed from slow to fast (1Hz--25Hz)

Channel	Function	Value	Description
		104--107	On
		108--207	From fast to slow
		208-- 212	On
		212--251	Random strobe
		251-- 255	On
12	Dimmer	0--255	From dark to bright
13	Dimmer adjust	0--255	Dimmer fine adjustment
14	Pan	0--255	Pan adjustment
15	Pan adjustment	0--255	Pan fine adjustment
16	Tilt	0--255	Tilt adjustment
17	Tilt adjustment	0--255	Tilt fine adjustment
18	Dimming Mode	0--42	Mode 1
		43--47	Mode 2
		48--52	Mode 3
		53--57	Mode 4
19	Reset	0--250	No function
		251--255	Reset within 5s
20	Zoom	0--255	From narrow to wide
21	Lens rotation	0--155	0~60°
		156--205	Clockwise infinite rotation
		206--255	Counterclockwise rotation
22	Pattern rotation	0--9	No function
		10--14	Monochrome dynamic pattern 1
		15--19	Monochrome dynamic pattern 2

Channel	Function	Value	Description
	(5 numbers 1 pattern)
		155--159	Monochrome pattern 30
		160--164	Mixed color dynamic pattern 1
		165--169	Mixed color dynamic pattern 2
	(5 numbers 1 pattern)
		220--224	Mixed color dynamic pattern 13
		225--255	Mixed color dynamic pattern 14
23	Pattern effect speed	0--9	No function
		10--132	Forward, from fast to slow(with 22CH)
		133--255	Reverse, from slow to fast (with 22CH)
24	Pattern effect fade	0--255	Pattern effect fade
25	Pattern Back R	0--255	Pattern effect R
26	Pattern Back G	0--255	Pattern effect G
27	Pattern Back B	0--255	Pattern effect B
28	Pattern Back	0--255	Pattern effect W
29	Pattern dimming	0--255	Pattern 0--100% dimming
30	Background dimming	0--255	Background 0--100% dimming
31	Static	0--255	Static
32	Pattern movement	0--255	Pattern movement (with 22CH)
33	Prospects strobe	0--255	Prospects strobe
34	Background strobe	0--255	Background strobe
35	Background pattern selection	0--255	Background selection

► 78CH Mode

Channel	Function	Value	Description
1	Red	0--255	Red dimming
2	Red adjustment	0--255	Red fine adjustment
3	Green	0--255	Green dimming
4	Green adjustment	0--255	Green fine adjustment
5	Blue	0--255	Blue dimming
6	Blue adjustment	0--255	Blue fine adjustment
7	White	0--255	White dimming
8	White adjustment	0--255	White fine adjustment
9	Color temperature	0--4	No function
		5--255	From warm to cold
10	Macro color	0--9	No function
		10--19	Macro color 1
		20--29	Macro color 2
	 (10 numbers 1 macro color)
		240--249	Macro color 24
		250--255	Macro color 25
11	Strobe	0--3	Off
		4--103	Synchro strobe speed from slow to fast (1Hz--25Hz)
		104--107	On
		108--207	From fast to slow
		208--212	On
		213--251	Random strobe
		251--55	On
12	Dimmer	0--255	From dark to bright
13	Dimmer adjust	0--255	Dimmer adjustment control
14	Pan	0--255	Pan adjustment
15	Pan adjustment	0--255	Pan fine adjustment
16	Tilt	0 --255	Tilt adjustment
17	Tilt adjustment	0--255	Tilt fine adjustment
18	Dimming Mode	0--42	Mode 1

Channel	Function	Value	Description
		43--47	Mode 2
		48--52	Mode 3
		53--57	Mode 4
19	Reset	0--250	No function
		251--255	Reset within 5s
20	Zoom	0--255	From narrow to wide
21	Lens rotation	0--155	0~60°
		156--205	Clockwise infinite rotation
		206--255	Counterclockwise rotation
22	R1 LED dimming	0--255	R1 LED dimming
23	G1 LED dimming	0--255	G1 LED dimming
24	B1 LED dimming	0--255	B1 LED dimming
25	R2 LED dimming	0--255	R2 LED dimming
26	G2 LED dimming	0--255	G2 LED dimming
27	B2 LED dimming	0--255	B2 LED dimming
.....
76	R19 LED dimming	0--255	R19 LED dimming
77	G19 LED dimming	0--255	G19 LED dimming
78	B19 LED dimming	0--255	B19 LED dimming

► 92CH Mode

Channel	Function	Value	Description
1	Red	0--255	Red dimming
2	Red adjustment	0--255	Red fine adjustment
3	Green	0--255	Green dimming
4	Green adjustment	0--255	Green fine adjustment
5	Blue	0--255	Blue dimming
6	Blue adjustment	0--255	Blue fine adjustment
7	White	0--255	White dimming
8	White adjustment	0--255	White fine adjustment
9	Color temperature	0 --4	No function
		5--255	From warm to cold

Channel	Function	Value	Description
		0--9	No function
10	Macro color	10--19	Macro color 1
		20--29	Macro color 2
	 (10 numbers 1 macro color)
10	Macro color	240--249	Macro color 24
		250--255	Macro color 25
11	Strobe	0--3	Off
		4--103	Synchro strobe speed slow to fast (1Hz--25Hz)
		104--107	On
		108--207	From fast to slow
		208--212	On
		212--251	Random strobe
		251--255	On
12	Dimmer	0--255	From dark to bright
13	Dimmer adjust	0--255	Dimmer adjustment control
14	Pan	0--255	Pan control
15	Pan adjustment	0--255	Pan adjustment control
16	Tilt	0--255	Tilt control
17	Tilt adjustment	0--255	Tilt adjustment control
18	Dimming Mode	0--42	Mode 1
		43-- 47	Mode 2
		48-- 52	Mode 3
		53-- 57	Mode 4
19	Reset	0--250	No function
		251--255	Reset within 5s
20	Zoom	0--255	From narrow to wide
21	Lens rotation	0--155	0~60°
		156--205	Clockwise infinite rotation
		206--255	Counterclockwise rotation
22	Pattern rotation	0--7	No function

Channel	Function	Value	Description
		8	Monochrome dynamic pattern 1
		9	Monochrome dynamic pattern 2
	(1 numbers 1 pattern)
		37	Monochrome pattern 30
		38	Mixed color dynamic pattern 1
		39	Mixed color dynamic pattern 2
	(1 umbers 1 pattern)
		50	Mixed color dynamic pattern 13
		51--255	Mixed color dynamic pattern 14
23	Pattern effect speed	0--9	No function
		10--132	Forward, from fast to slow (with 22CH)
		133--255	Reverse, from slow to fast (with 22CH)
24	Pattern effect fade	0--255	Pattern effect fade
25	Pattern Back R	0--255	Pattern effect R
26	Pattern Back G	0--255	Pattern effect G
27	Pattern Back B	0--255	Pattern effect B
28	Pattern Back W	0--255	Pattern effect W
29	Pattern dimming	0--255	Pattern 0--100% dimming
30	Back Dimming	0--255	Background 0--100% dimming
31	Pattern change	0--255	Pattern change control
32	Pattern movement	0--255	Pattern movement (with 22CH)
33	Prospects strobe	0--255	Prospects strobe
34	Background strobe	0--255	Background strobe
35	Background pattern selection	0--255	Background selection
36	LED1 R	0--255	LED1 R dimming

Channel	Function	Value	Description
37	LED1 G	0--255	LED1 G dimming
38	LED1 B	0--255	LED1 B dimming
.....
90	LED19 R	0--255	LED 19 R dimming
91	LED19 G	0--255	LED19 G dimming
92	LED19 B	0--255	LED 19 B dimming

► 97CH Mode

Channel	Function	Value	Description
1	Red	0--255	Red dimming
2	Red adjustment	0--255	Red fine adjustment
3	Green	0--255	Green dimming
4	Green adjustment	0--255	Green fine adjustment
5	Blue	0--255	Blue dimming
6	Blue adjustment	0--255	Blue fine adjustment
7	White	0--255	White dimming
8	White adjustment	0--255	White fine adjustment
9	Color temperature	0 --4	No function
		5--255	From warm to cold
10	Macro color	0--9	No function
		10--19	Macro color 1
		20--29	Macro color 2
	 (10 numbers 1 macro color)
		240--249	Macro color 24
		250--255	Macro color 25
11	Strobe	0--3	Off
		4--103	Synchro strobe speed slow to fast (1Hz--25Hz)
		104--107	On
		108--207	From fast to slow
		208--212	On
		213--251	Random strobe

Channel	Function	Value	Description
		252--255	On
12	Dimmer	0--255	From dark to bright
13	Dimmer adjust	0--255	Dimmer adjustment control
14	Pan	0--255	Pan adjustment
15	Pan adjustment	0--255	Pan fine adjustment
16	Tilt	0--255	Tilt adjustment
17	Tilt adjustment	0--255	Tilt fine adjustment
18	Dimming Mode	0--42	Mode 1
		43-- 47	Mode 2
		48--52	Mode 3
		53--57	Mode 4
19	Reset	0--250	No function
		251--255	Reset within 5s
20	Zoom	0--255	Angle from narrow to wide
21	Lens rotation	0--155	0~60°
		156--205	Clockwise infinite rotation
		206--255	Counterclockwise rotation
22	R1 LED dimming	0--255	R1 LED dimming
23	G1 LED dimming	0--255	G1 LED dimming
24	B1 LED dimming	0--255	B1 LED dimming
25	W1 LED dimming	0--255	W1 LED dimming
.....
94	R19 LED dimming	0--255	R19 LED dimming
95	G19LED dimming	0--255	G19 LED dimming
96	B19LED dimming	0--255	B19 LED dimming
97	W19LED dimming	0--255	W19 LED dimming

► 99CH Mode

Channel	Function	Value	Description
1	Pan	0--255	0--540°
2	Pan adjustment	0--255	16bit adjustment
3	Tilt	0--255	0--205°

Channel	Function	Value	Description
4	Tilt adjustment	0--255	16bit adjustment
5	XY speed	0--255	Speed from fast to slow
6	Zoom	0--255	From small to large
7	Lens rotation	0--155	0~60°
		156--205	Clockwise infinite rotation from fast to slow
		206--255	Counterclockwise rotation from slow to fast
8	Dimmer	0--255	From dark to bright
9	Strobe	0--3	Off
		4--103	Synchro strobe speed from slow to fast (1Hz--25Hz)
		104--107	On
		108--207	From fast to slow
		208--212	On
		213--251	Random strobe
		252--255	On
10	R dimming	0--255	From dark to bright
11	G dimming	0--255	From dark to bright
12	B dimming	0--255	From dark to bright
13	W dimming	0--255	From dark to bright
14	Color temperature	0 --4	No function
		251--255	From warm to cold
15	Macro color	0--9	No function
		10--19	Macro color 1
		20--29	Macro color 2
	 (10 numbers 1 macro color)
		240--249	Macro color 24
		250--255	Macro color 25
16	Static pattern	0--9	No function

Channel	Function	Value	Description
		10--12	Monochrome pattern 1
		13--15	Monochrome pattern 2
	(3 numbers 1 pattern)
		208--210	Monochrome pattern 67
		211--213	Mixed color pattern 1
		214--216	Mixed color pattern 2
	 (3 numbers 1 pattern)
		250--252	Mixed color pattern 14
		253--255	Mixed color pattern 15
17	Dynamic pattern	0--9	No function
		10--14	Monochrome dynamic pattern 1
		15--19	Monochrome dynamic pattern 2
	(5 numbers 1 pattern)
		155--159	Monochrome pattern 30
		160--164	Mixed color dynamic pattern 1
		165--169	Mixed color dynamic pattern 2
	(5 numbers 1 pattern)
		220--224	Mixed color dynamic pattern 13
		225--255	Mixed color dynamic pattern 14
18	Dynamic pattern speed	0--127	Forward, from fast to slow (with 17CH)
		128--255	Reverse, from slow to fast (with 17CH)

Channel	Function	Value	Description
19	Background R	0--255	dark to bright linear dimming
20	Background G	0--255	dark to bright linear dimming
21	Background B	0--255	dark to bright linear dimming
22	Background W	0--255	dark to bright linear dimming
23	Reset	0--250	No function
		250--255	Reset within 5s
24	R1 LED dimmer	0--255	R1 LED dimming
25	G1LED dimmer	0--255	G1 LED dimming
26	B1 LED dimmer	0--255	B1 LED dimming
27	W1LED dimmer	0--255	W1 LED dimming
.....
96	R19 LED dimmer	0--255	R19 LED dimming
97	G19 LED dimmer	0--255	G19 LED dimming
98	B19 LED dimmer	0--255	B19 LED dimming
99	W19 LED dimmer	0--255	W19 LED dimming

8. Mounting

When installing the unit, the trussing or area of installation must be able to hold 10 times the weight without any deformation. When installing the unit must be secured with a secondary safety attachment, e.g. an appropriate safety cable. Never stand directly under the facility while mounting, uninstalling or repairing facilities.

High-altitude mounting requires for extensive experience, including working load limits calculating , installation material, and periodic safety check of installation materials and facilities. If you're lack of mentioned qualifications, do not attempt the installation yourself. These installation should be checked by a skilled person annually.

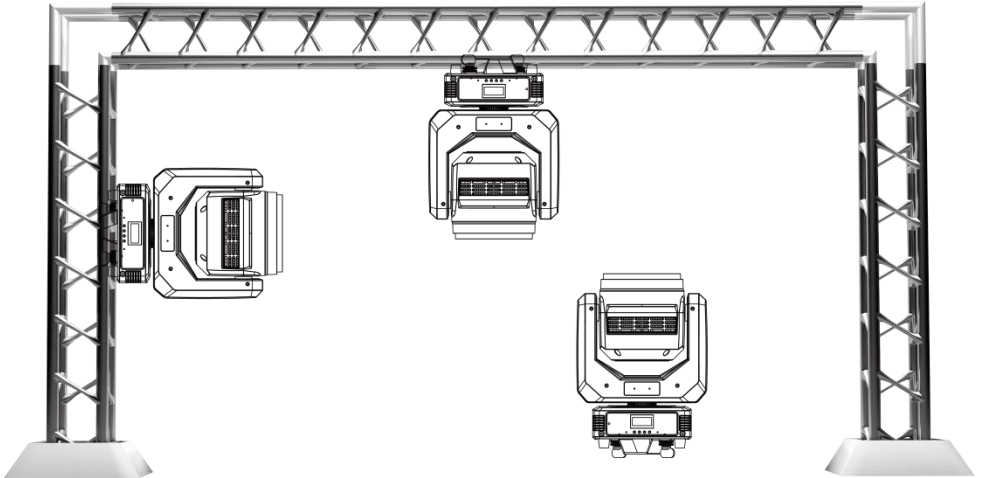

1920B works properly in above different mounting, hanging upside-down from a ceiling, sideways on trussing, or set on smooth horizontal surface. Be sure this facility is at least 12m (40ft) away from flammable materials (decoration

etc.). Always use and install the safety cable to prevent accidental damage or injury from the facility failure. Never use handles for secondary attachment.

NOTICE: The suitable environment temperature of the facility is from -25° C to 45° C. Do not place this facility in an environment where the temperatures are under or above the temperatures stated. This will help the fixture run at its best and extend the lifetime.

9. Product Size

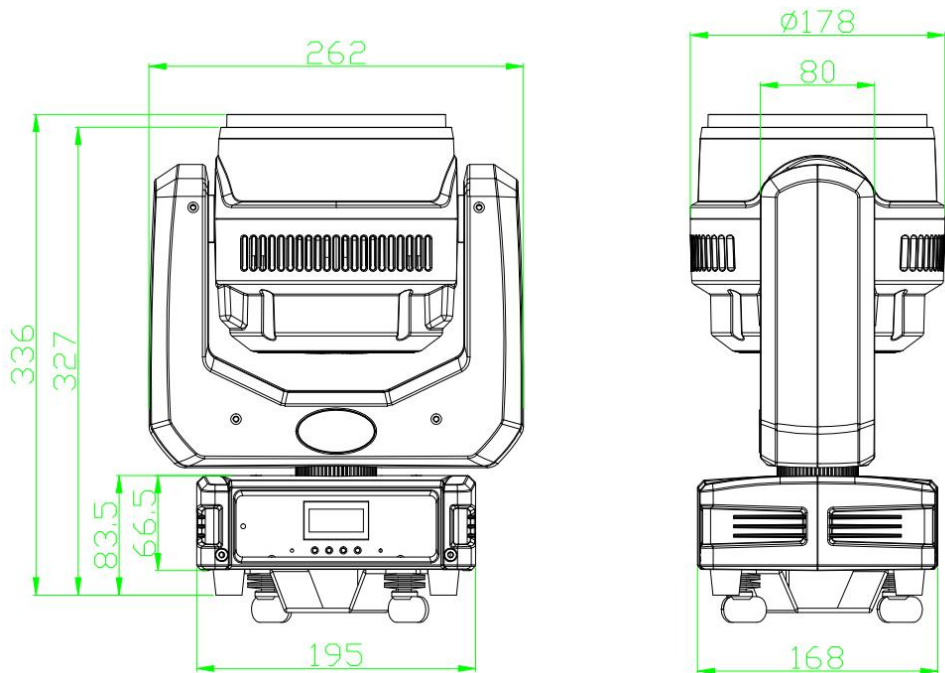

10. Attention

1. When the facility is powered on, please avoid looking directly at the facility.
2. When assembling/ replacing LED, be sure to cut off the main power of facilities before opening the cover upon the LED board.

11. Trouble Shooting

Following are a few common problems that may occur during operation. Here are some suggestions for easy troubleshooting:

A. The unit does not work, no light and the fan does not work

1. Check the status of power connection and fuse.
2. Check the voltage.
3. Check the power indicator.

B. No response to DMX controller

1. If the display screen flashes, check the DMX signal connector and signal line whether the connection is correct.
1. If the display screen does not flash, but no response to channel control, check whether the address code or channel setting is correct.
1. If the DMX signal transmission is intermittent, check if the XLR and DMX cables are in good condition.
2. Try using another controller.
3. Check if the DMX cables is too close to the high-voltage wire, which may damage or interfere with the signal circuit.
6. The facility has not completed the self-check.

C. One of the channels is not working well

1. The stepper motor might be damaged or the cable connected to the PCB is broken.
2. The motor's drive IC on the PCB might be out of condition.

12. Fixture Cleaning

The lens and diffuser should be clean frequently to get better light effect. Wipe frequency according to the environment. Humidity, excessive smoke, and dirty environment will make lens dusty.

- Use soft cloth and special glass cleaner.
- Wipe lens surface at least every 30 days.
- Use vacuum cleaners or air guns to clean the interior structure of the facility, at least twice a year.



Warning:

To avoid the danger of lighting strikes and fire, please do not place the facility in a humid environment. Do not disassemble it without permission, otherwise, the manufacturer will not provide warranty. If the facility fails, please contact the manufacturer first.

Product Warranty Card

Product: 19x20W Bee Eye Zoom

Model NO.: 1920B

Manufacture Date:

User:

Purchase Date:

Manufacturer:

Sales Store:

Address:

ATTN.:

ATTN.:

Phone:

Phone:

Note: The above blank must be filled in and sealed by the end user or sales point, otherwise no warranty will be provided. (Below please check the warranty period and terms)

Warranty Period: This facility is warranted for 2 years from the date of purchase.

Warranty Terms:

1. Except for man-made damage and natural disasters
2. If the facility fails to function properly during the warranty period, please contact our after service department or our local distributor directly.
 - 1) Fail to present a valid warranty card.
 - 2) Omissions, alterations, and trade sales names on the warranty card.
 - 3) Failures and damage caused by force majeure.
 - 4) Failures and damage caused during transportation and handling.
 - 5) Failures and damage caused by failure to follow the instructions for use.
 - 6) Failures and damage caused by disassembly, repair, and modification of the product without the manufacturer's authorization or by non-professionals.
 - 7) Failures caused by the use of accessories not approved by the factory or not matched by the factory.

▲ Thank you for reading this manual. Please keep it for future reference.